



2022

COOLING ESSENTIALS

2020



Featuring **NEW** Products from:





TABLE OF CONTENTS

AC HARD STARTS	3-4
LINEBACKER®.....	5-12
AC INSTALLATION & SERVICE	13
AC & REFRIGERATION SERVICE	14-16
COMMERCIAL REFRIGERATION.....	17
CONDENSATE MANAGEMENT	18-21
SUPCO® STAPLES	22
TRADEFOX® TECHNICIAN-INVENTED PRODUCTS.....	23-31
THERMOSTATS	32
INDOOR AIR QUALITY	33
HVAC	34-35
SOLDERWELD® BRAZING & SOLDERING	36
DURO-LINE™ STEEL LINE SETS	37
PIPE VISE™ PREMIUM PIPE TOOLS	38
SB1® PUSH-TO-CONNECT REFRIGERANT FITTINGS	39

As the Pioneer of the Two-Wire Hard Start Kit, SUPCO offers a Hard Start technology to meet every system need and budget.

HOW TO CHOOSE THE RIGHT HARD START KIT:

SYSTEMS WITH FIXED ORIFICES

PTC Technology | 2-Wire Only



- ✓ EASY TWO-WIRE INSTALLATION
- ✓ INCREASES TORQUE UP TO 600%
- ✓ LOW COST & DURABLE

Supco® P/N	Increase In Torque
SPP	250%
SPP5	300%
SPP6	500%
SPP7S	600%



References to original equipment and other manufacturers' names, models, trademarks and part numbers are used for identification purposes only and SUPCO® replacement products are not in any way affiliated, endorsed or sponsored by such manufacturers.

SYSTEMS WHERE A TXV IS USED

Mechanical Potential Relay Technology | **2-Wire**



- ✓ EASY TWO-WIRE INSTALLATION
- ✓ ALSO AVAILABLE WITH RELAY COVER
- ✓ INSTANT RECYCLING
- ✓ TWO KITS COVER SYSTEMS UP TO 5 TONS

Supco® P/N	Application	Capacitor Size (µF)	Can Substitute for Kickstart®
WITHOUT RELAY COVER			
SPR5	1 - 3 ton	189-227 µF	TO-5
SPR1	3.5 - 5 ton	270-324 µF	KS-1
WITH RELAY COVER			
MPR5	1 - 3 ton	189-227 µF	TO-5
MPR1	3.5 - 5 ton	270-324 µF	KS-1

SYSTEMS WHERE A TXV IS USED

Mechanical Potential Relay Technology | **3-Wire**



- ✓ EZ-SNAP BRACKET INCLUDED FOR MOUNTING
- ✓ THREE-WIRE MOST SIMILAR TO OEM STYLE
- ✓ CHOOSE A CLOSELY MATCHED RELAY AND CAPACITOR

Supco® P/N	Application	Capacitor Size (µF)	Can Substitute for 5-2-1®
3W1	1 - 3 ton	88 - 108 µF	CSRU1
3W2	3.5 - 5 ton	189 - 227 µF	CSRU2
3W3	4 - 5 ton	270 - 324 µF	CSRU3

2 PARTS REPLACE 1-5 TONS - 3W1, 3W2

SYSTEMS WHERE A TXV IS USED

Electronic Potential Relay Technology | **2-Wire Only**



- ✓ EASY TWO-WIRE INSTALLATION
- ✓ ONE KIT (SPP8E) COVERS 1 TON AND UP
- ✓ BACKUP SAFETY TIMER PROTECTS COMPRESSOR FROM OVERHEATING

Supco® P/N	Application	Capacitor Size (µF)
SPP6E	1/2 - 3 hp	88-106 µF
SPP7E	1 - 4 hp	130-156 µF
SPP8E	1 - 5 hp	189-227 µF
SPP10E	3 hp and up	270-324 µF

References to original equipment and other manufacturers' names, models, trademarks and part numbers are used for identification purposes only and SUPCO® replacement products are not in any way affiliated, endorsed or sponsored by such manufacturers.



LINEBACKER®

CAPACITORS

CONTACTORS

FAN RELAYS

POTENTIAL RELAYS

TRANSFORMERS

**WHIPS &
DISCONNECTS**



NEVER SETTLE FOR JUST GOOD ENOUGH

Linebacker® Motor Run Capacitors are built for longevity and performance. Engineered by an ISO certified manufacturer with over twenty years' experience in OEM capacitor fabrication, Linebacker® capacitors come off the same production line as the OEM, and are 100% in-line production tested to the same rigorous international standards.

Built Tough | Meets EIA-456A accelerated life test at 70° C for 60,000 hours

Works Harder | Life tested to 85° C operating temperature for 10,000 cycles

Approved | US and Canada UL approved. File number: E352486 (C22.2NO.190)

Protected | 10,000 AFC pressure sensitive short circuit interrupting capability

Tested | Continuous life tested, oil leak tested and dielectric tested for insulation effectiveness



THE GUTS TO GET IT DONE.

Linebacker® capacitors are manufactured with thick polypropylene foil to handle increased operating temperatures, and PCB-free oil to prevent over-heating.

Voltage	Up to 440 VAC
Standard Tolerance	+/- 5%
Operating Temperature	-40° C to 85° C
Foil Thickness	6.0 μm +/- 5%

SLIM YOUR STOCK

(Trust us, it works.)

A common misconception is that you must have a 370V capacitor to replace a 370V capacitor. However, the voltage rating on a run capacitor displays the voltage that should not be exceeded. Stocking Linebacker® capacitors means with less parts you can handle applications up to 440V, so those 370V applications are good to go. Now you can start making plans for that extra shelf space you've just gained.

WE'VE GOT YOUR BACK.

Premium performance, not price. SUPCO's long-standing reputation in manufacturing and sourcing allows us to offer a top-grade capacitor at extremely competitive market prices.



SINGLE ROUND

Supco® P/N	MF Rating
LCR10X440R	10 MFD X 440V
LCR12.5X440R	12.5 MFD X 440V
LCR15X440R	15 MFD X 440V
LCR17.5X440R	17.5 MFD X 440V
LCR20X440R	20 MFD X 440V
LCR25X440R	25 MFD X 440V
LCR2X440R	2 MFD X 440V
LCR30X440R	30 MFD X 440V
LCR35X440R	35 MFD X 440V
LCR3X440R	3 MFD X 440V
LCR40X440R	40 MFD X 440V
LCR45X440R	45 MFD X 440V
LCR4X440R	4 MFD X 440V
LCR50X440R	50 MFD X 440V
LCR55X440R	55 MFD X 440V
LCR5X440R	5 MFD X 440V
LCR60X440R	60 MFD X 440V
LCR6X440R	6 MFD X 440V
LCR7.5X440R	7.5 MFD X 440V
LCR70X440R	70 MFD X 440V
LCR80X440R	80 MFD X 440V
LCR90X440R	90 MFD X 440V

SINGLE OVAL

Supco® P/N	MF Rating
LCR10X440	10 MFD X 440V
LCR12.5X440	12.5 MFD X 440V
LCR15X440	15 MFD X 440V
LCR17.5X440	17.5 MFD X 440V
LCR2.5X440	2.5 MFD X 440V
LCR20X440	20 MFD X 440V
LCR25X440	25 MFD X 440V
LCR2X440	2 MFD X 440V
LCR30X440	30 MFD X 440V
LCR35X440	35 MFD X 440V
LCR3X440	3 MFD X 440V
LCR40X440	40 MFD X 440V
LCR45X440	45 MFD X 440V
LCR4X440	4 MFD X 440V
LCR50X440	50 MFD X 440V
LCR55X440	55 MFD X 440V
LCR5X440	5 MFD X 440V
LCR60X440	60 MFD X 440V
LCR65X440	65 MFD X 440V
LCR6X440	6 MFD X 400V
LCR7.5X440	7.5 MFD X 440V
LCR70X440	70 MFD X 440V
LCR75X440	75 MFD X 440V
LCR80X440	80 MFD X 440V

DUAL ROUND

Supco® P/N	MF Rating
LCD10+5X440R	10+5 MFD X 440V
LCD15+5X440R	15+5 MFD X 440V
LCD20+15X440R	20+15 MFD X 440V
LCD20+5X440R	20+5 MFD X 440V
LCD25+10X440R	25+10 MFD X 440V
LCD25+15X440R	25+15 MFD X 440V
LCD25+3X440R	25+3 MFD X 440V
LCD25+5X440R	25+5 MFD X 440V
LCD25+7.5X440R	25+7.5 MFD X 440V
LCD30+3X440R	30+3 MFD X 440V
LCD30+4X440R	30+4 MFD X 440V
LCD30+5X440R	30+5 MFD X 440V
LCD30+7.5X440R	30+7.5 MFD X 440V
LCD35+10X440R	35+10 MFD X 440V
LCD35+3X440R	35+3 MFD X 440V
LCD35+4X440R	35+4 MFD X 440V
LCD35+5X440R	35+5 MFD X 440V
LCD35+6X440R	35+6 MFD X 440V
LCD35+7.5X440R	35+7.5 MFD X 440V
LCD40+10X440R	40+10 MFD X 440V
LCD40+3X440R	40+3 MFD X 440V
LCD40+4X440R	40+4 MFD X 440V
LCD40+5X440R	40+5 MFD X 440V
LCD40+6X440R	40+6 MFD X 440V
LCD40+7.5X440R	40+7.5 MFD X 440V
LCD45+10X440R	45+10 MFD X 440V
LCD45+3X440R	45+3 MFD X 440V
LCD45+4X440R	45+4 MFD X 440V
LCD45+5X440R	45+5 MFD X 440V

DUAL OVAL

Supco® P/N	MF Rating
LCD10+5X440	10+5 MFD X 440V
LCD15+4X440	15+4 MFD X 440V
LCD15+5X440	15+5 MFD X 440V
LCD20+15X440	20+15 MFD X 440V
LCD20+5X440	20+5 MFD X 440V
LCD25+10X440	25+10 MFD X 440V
LCD25+5X440	25+5 MFD X 440V
LCD25+7.5X440	25+7.5 MFD X 440V
LCD30+10X440	30+10 MFD X 440V
LCD30+4X440	30+4 MFD X 440V
LCD30+5X440	30+5 MFD X 440V
LCD30+7.5X440	30+7.5 MFD X 440V
LCD35+10X440	35+10 MFD X 440V
LCD35+3X440	35+3 MFD X 440V
LCD35+4X440	35+4 MFD X 440V
LCD35+5X440	35+5 MFD X 440V
LCD35+7.5X440	35+7.5 MFD X 440V

Supco® P/N	MF Rating
LCD45+6X440R	45+6 MFD X 440V
LCD45+7.5X440R	45+7.5 MFD X 440V
LCD50+10X440R	50+10 MFD X 440V
LCD50+12.5X440R	50+12.5 MFD X 440V
LCD50+5X440R	50+5 MFD X 440V
LCD50+7.5X440R	50+7.5 MFD X 440V
LCD55+10X440R	55+10 MFD X 440V
LCD55+5X440R	55+5 MFD X 440V
LCD55+7.5X440R	55+7.5 MFD X 440V
LCD60+10X440R	60+10 MFD X 440V
LCD60+12.5X440R	60+12.5 MFD X 440V
LCD60+15X440R	60+15 MFD X 440V
LCD60+3X440R	60+3 MFD X 440V
LCD60+5X440R	60+5 MFD X 440V
LCD60+7.5X440R	60+7.5 MFD X 440V
LCD65+10X440R	65+10 MFD X 440V
LCD65+5X440R	65+5 MFD X 440V
LCD70+10X440R	70+10 MFD X 440V
LCD70+5X440R	70+5 MFD X 440V
LCD70+7.5X440R	70+7.5 MFD X 440V
LCD75+10X440R	75+10 MFD X 440V
LCD75+5X440R	75+5 MFD X 440V
LCD75+7.5X440R	75+7.5 MFD X 440V
LCD80+10X440R	80+10 MFD X 440V
LCD80+5X440R	80+5 MFD X 440V
LCD80+7.5X440R	80+7.5 MFD X 440V
LCD85+10X440R	85+10 MFD X 440V
LCD85+5X440R	85+5 MFD X 440V
LCD85+7.5X440R	85+7.5 MFD X 440V

Supco® P/N	MF Rating
LCD35+8.5X440	35+8.5 MFD X 440V
LCD40+3X440	40+3 MFD X 440V
LCD40+5X440	40+5 MFD X 440V
LCD40+7.5X440	40+7.5 MFD X 440V
LCD45+5X440	45+5 MFD X 440V
LCD45+7.5X440	45+7.5 MFD X 440V
LCD50+5X440	50+5 MFD X 440V
LCD50+7.5X440	50+7.5 MFD X 440V
LCD55+10X440	55+10 MFD X 440V
LCD55+5X440	55+5 MFD X 440V
LCD60+5X440	60+5 MFD X 440V
LCD60+7.5X440	60+7.5 MFD X 440V
LCD65+10X440	65+10 MFD X 440V
LCD65+7.5X440	65+7.5 MFD X 440V
LCD80+10X440	80+10 MFD X 440V
LCD80+5X440	80+5 MFD X 440V
LCD80+7.5X440	80+7.5 MFD X 440V

POTENTIAL RELAYS

UNIVERSAL POTENTIAL RELAYS

(wire-to-wire)



SUPR

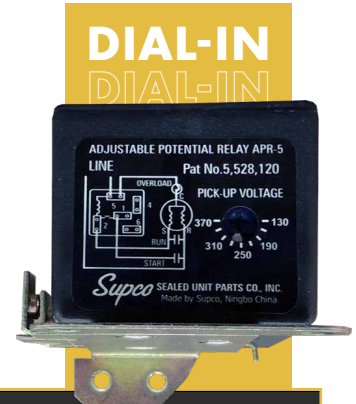

APR5

UNIVERSAL POTENTIAL RELAY	
Time Function	RELAY TYPE
Electronic Potential Relay (EPR)	RELAY TECHNOLOGY
1.0 to 1.5 Seconds	SAFETY TIMEOUT
110 - 270 VAC	OPERATING VOLTAGE
30 AMPS	AMPERAGE
Single-Phase Up to 5hp	MOTOR POWER RATING
Screw-On or Push-On	TERMINALS
Universal Mounting Bracket	MOUNTING
1.75"W x 2.25"L x 1.50"H	DIMENSIONS

| UL® File no: E146162

ADJUSTABLE POTENTIAL RELAY	
Adjustable Voltage Sensing	
Electronic Potential Relay (EPR)	
1.0 to 1.5 Seconds	
110 - 270 VAC	
30 AMPS	
Single-Phase Up to 5hp	
Screw-On or Push-On	
Universal Mounting Bracket	
1.75"W x 2.25"L x 1.50"H	

SUPCO® LINEBACKER®

90XX SERIES POTENTIAL RELAYS

| Voltage sensitive relay

| Safety time delay

| UL® Approval: E146162

| Instant re-start

| Use with any size suitable start capacitor

Supco® P/N	Continuous Coil Voltage	Pick-Up Min.	Pick-Up Max.	Drop Max.
9063	168	140	153	45
9064	395	242	272	140
9065	332	171	184	90
9066	395	204	233	130
9067	420	280	310	121
9068	502	314	342	135
9069	338	180	195	105
9070	332	285	305	85
9071	420	223	259	121



GENERAL PURPOSE FAN RELAYS

General Purpose Fan Relays used on many HVAC/R and Industrial applications.

| Single or Double Pole | UL® Approval: E315222

| Meets All Safety Requirements

Supco® P/N	Type	FLA 250V	LRA 250V	Coil Voltage
90290	SPST	8	18	24V
90291	SPST	8	25	120V
90292	SPST	8	25	240V
90293	SPDT	8	18	24V
90294	SPDT	8	25	120V
90295	SPDT	8	25	240V

Supco® P/N	Type	FLA 125V	LRA 125V	FLA 250V	LRA 250V	Coil Voltage
90370	SPDT	12	60	8	48	24V
90372	SPDT	14	84	8	48	120V
90374	SPDT	14	84	8	48	240V
90380	NO/NC	12	60	8	48	24V
90382	NO/NC	12	60	8	48	120V
90384	NO/NC	12	60	8	48	240V



SUPCO® LINEBACKER®

903X SERIES SWITCHING FAN RELAYS (double pole double throw)

Provides general purpose switching for refrigeration and air conditioning equipment and appliances. UL File No: E328772

Supco® P/N	Coil Voltage	FLA 120V	FLA 208V	FLA 240V	FLA 277V	HP	Essex®/RBM®	Honeywell®
90340	24	13.8	7.6	6.9	6	3/4	90-340	R8222D1014
90341	120	13.8	7.6	6.9	6	3/4	90-341	R4222D1013
90342	208/240	13.8	7.6	6.9	6	3/4	90-342	R4222N1021



References to original equipment and other manufacturers' names, models, trademarks and part numbers are used for identification purposes only and SUPCO® replacement products are not in any way affiliated, endorsed or sponsored by such manufacturers.

orders@supco.com

DEFINITE PURPOSE CONTACTORS

Designed for use in HVAC&R system and available in 1.5, 2 and 3 pole configurations from 20 through 90 full amps. Compact universal design allows replacement of the most common brands.

- | Silver cadmium oxide contacts
- | Space saving dimensions
- | Compact universal design and interchangeable mounting plate allow for easy replacement of most brands.
- | Economically priced
- | A2L Certified File Number: E328772



1.5 POLE

Supco® P/N	Full Load Amps	Coil Voltage
DP25241	25	24
DP251201	25	120
DP252401	25	240
DP30241	30	24
DP301201	30	120
DP302401	30	240

2 POLE

Supco® P/N	Full Load Amps	Coil Voltage
DP20242	20	24
DP201202	20	120
DP202402	20	240
DP25242	25	24
DP251202	25	120
DP252402	25	240
DP30242	30	24
DP301202	30	120
DP302402	30	240
DP40242	40	24
DP401202	40	120
DP402402	40	240

3 POLE

Supco® P/N	Full Load Amps	Coil Voltage
DP25243	25	24
DP252403	25	240
DP254803	25	480
DP30243	30	24
DP301203	30	120
DP302403	30	240
DP304803	30	480
DP40243	40	24
DP401203	40	120
DP402403	40	240
DP404803	40	480
DP50243	50	24

Supco® P/N	Full Load Amps	Coil Voltage
DP501203	50	120
DP502403	50	240
DP60243	60	24
DP601203	60	120
DP602403	60	240
DP75243	75	24
DP751203	75	120
DP752403	75	240
DP90243	90	24
DP901203	90	120
DP902403	90	240

2 POLE MAGNETIC LINE CONTACTOR

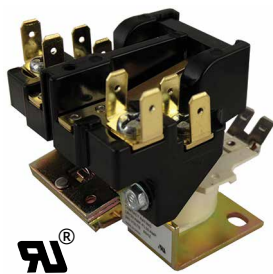

Designed to replace 2 pole, 30 amp contactors used in AC and electric heat applications to control the blower motors.

Supco® P/N
SMC11

- | Non-Positional
- | Includes 4 Terminals and 4 Screws
- | Replaces Mars® 18001 (exact) and Honeywell® R850B1146, Packard® C18001
- | UL® File Number E328772

3 POLE AUXILIARY SWITCH (for contactors)

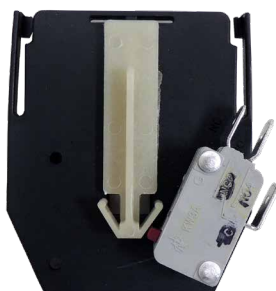

Used to add additional load switching capability for other low load accessories that need to be controlled with the start/stop sequence of the equipment.

UL® File Number: E328772

Supco® P/N	Contactors	Current	Switch Action
DPAUX1	25A to 40A	10A at 300 VAC	SPDT (1)
DPAUX3	25A to 40A	10A at 600 VAC	(1) SPNO, (1) SPNC
DPAUX4	25A to 40A	10A at 600 VAC	SPNO (2)
DPAUX6	75A to 90A	10A at 300 VAC	SPDT (2)

References to original equipment and other manufacturers' names, models, trademarks and part numbers are used for identification purposes only and SUPCO® replacement products are not in any way affiliated, endorsed or sponsored by such manufacturers.

UNIVERSAL TRANSFORMER

- | 50/60 Hz
- | Enclosed frame - plate, foot or knock-out mount
- | Includes 4"x4" mounting plate, wire nuts, 1/2" conduit & 8" leads

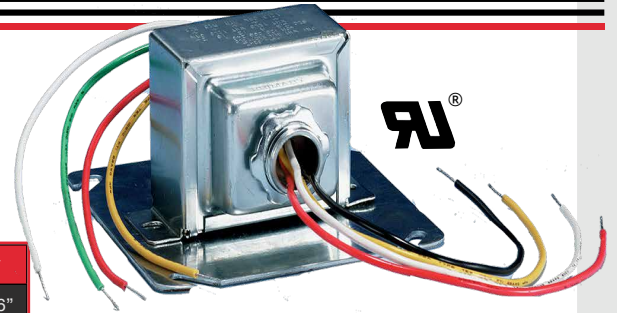

Supco® P/N	VAC	Primary VAC	Secondary VAC	H	W	D	MW
T45	48	120/208/240	2.5, 8, 12, 16 & 24	2 1/16"	3 1/4"	2 3/4"	2 13/16"

CONTROL TRANSFORMERS

Supco® P/N	Primary VAC	Secondary VAC	Output VAC	Breaker/Fuse	Agency
SXT100R	120/208/240/480	24	100	Breaker	UR®
SXT101	120/208/240	2.5/12/24	40	Fuse	UR®
SXT105	120/208/240	24	40	No	UR®
SXT114	120/208/240	24	20	No	UR® CSA®
SXT115*	120/208/240	24	40	No	UR® CSA®
SXT116	120	24	40	No	UR® CSA®
SXT79R	120/208/240/480	24	75	Breaker	UR®



*Includes Metal Shroud

MULTI-MOUNT TRANSFORMERS

Supco® P/N	Primary VAC	Secondary VAC	Output VAC	Breaker/Fuse
SXT106	120/208/240	24	40	No
SXT111	120/208/240	2.5/12/24	40	Fuse
SXT113	208/240	40	40	No
SXT150	120/208/240	24	50	Fuse

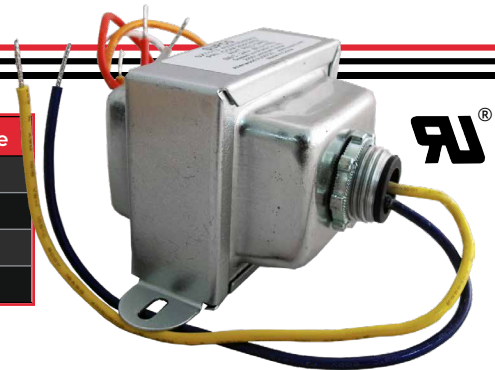

UNIVERSAL FAN CENTERS

- | DPDT plug-in style relay (90340) | Color coded wiring for easy installation
- | 40 VA transformer | Universal FC4031 includes multi-tap primary voltages for all applications, reduces inventory
- | Mounts directly to 4" x 4" electrical box

Supco® P/N	VAC	Primary VAC	Secondary VAC	HP	Jard®	Mars®	Steveco®
FC4011	40	120	24	3/4	4011FC	24013	90-113
FC4031	40	120/208/240	24	3/4	4031FC	24010	90-130



References to original equipment and other manufacturers' names, models, trademarks and part numbers are used for identification purposes only and SUPCO® replacement products are not in any way affiliated, endorsed or sponsored by such manufacturers.

WHIPS & DISCONNECTS

HVAC/ELECTRICAL WHIPS | NON-METALLIC

- | Three distinct wire colors for easy hook-up
- | (1) Straight Non-Metallic Connector
- | (1) 90° Non-Metallic Connector
- | Liquid Tight Conduit

USE WITH:

- Air Conditioners
- Heat Pumps
- Motors
- Swimming Pools
- Hot Tubs
- Similar Equipment

CONNECTOR STYLE	1-STRAIGHT, 1-90°
CONNECTOR TYPE	LIQUID TIGHT
MAX VOLTS	600
WIRE TYPE	3-10AWG
	2-8AWG, 1-10AWG
UL LISTED	YES



Supco® P/N	Description	Gauge	Length	Diameter	Type
WPNM8G344	HVAC/Electrical Whip	8GA	4'	3/4"	Non Metallic
WPNM8G346	HVAC/Electrical Whip	8GA	6'	3/4"	Non Metallic
WPNM8G348	HVAC/Electrical Whip	8GA	8'	3/4"	Non Metallic
WPNM10G124	HVAC/Electrical Whip	10 GA	4'	1/2"	Non Metallic
WPNM10G126	HVAC/Electrical Whip	10 GA	6'	1/2"	Non Metallic
WPNM10G128	HVAC/Electrical Whip	10 GA	8'	1/2"	Non Metallic

NON-FUSED METALLIC DISCONNECT

- | Non-Fused
- | NEMA Rating 3R
- | Heavy Gauge Steel
- | Folding Pivot Locking Tab
- | Bottom, Side and Rear Knockouts
- | Applications: HVAC/R, Pools, Hot Tubs, and Outdoor Lighting

VOLTS	240V
AMPS	60A
PHASES	SINGLE
FUSE	NON-FUSED
NEMA RATING	TYPE 3R
UL LISTED	YES
SALT SPRAY TEST	QUALIFIED 72 HOURS
# KNOCKOUTS	6 X 1"



SUPCO® P/N:
DISC60NF



LIGHT meets MIGHT



PORT-A-BLASTER®

Weighing only 11 lbs., this rugged coil cleaning machine blasts dirt from evaporator and condenser coils using a patented, pressure activated pump.

Supco® P/N
ZPB140

- Lightweight for easy carrying
- Two pressure settings for mini-split indoor coils and outdoor coils
- Includes durable quick-connect hoses, wand, and trigger sprayer
- On-board storage cabinet for all accessories
- Durable construction and rugged housing
- Volts 120 VAC
- Watts 80 W
- Flow Rate 0.25 GPM
- Max. Pressure 140 PSI
- Temperature Range: 35° to 120°F.
- Size 12"H x 7"W x 11.5"L
- Handle 1.5"W

30" EXTENSION WAND & 90°

Supco® P/N
ZPBE90



MINI-SPLIT CATCH ALL™

- Fully adjustable from 47" x 25" for wall unit, to 47" x 47" for ceiling units
- Durable construction and material for multi-use
- Includes storage and carry bag

Supco® P/N
ZCA24



MINI-FIT™ FLEXIBLE MINI-SPLIT ADAPTER

- Adapts 1/4" hose fitting to 5/16" Mini-Split R-410A fitting
- Eases access to service ports in tight fitting ductless condensing unit applications
- High Quality Brass Design with high pressure hose
- Rated for use with all refrigerants

Supco® P/N
ZMF56

LIQUID LINE FILTER DRIERS



FLARE SAE

SOLDER ODF

Supco® P/N	Supco® P/N	Supco® P/N	Supco® P/N
LLD032	LLD084	LLD032S	LLD163S
LLD052	LLD163	LLD052S	LLD164S
LLD053	LLD164	LLD053S	LLD165S
LLD082	LLD304	LLD082S	LLD304S
LLD083		LLD083S	LLD305S
		LLD084S	LLD307S

HP SERIES BI-DIRECTIONAL



FLARE SAE

SOLDER ODF

Supco® P/N	Supco® P/N
HP083	HP083S
HP163	HP163S
HP164	HP165S



SSLD SERIES SUCTION LINE DRIERS



SOLDER ODF

Supco® P/N	Connection Size	Cubic Inches	Tonnage
SSLD165S	5/8"	16	1 to 3-1/4
SSLD166S	3/4"	16	1 to 3-1/4
SSLD167S	7/8"	16	1 to 3-1/4
SSLD307S	3/4"	30	2 to 4-1/2
SSLD306S	7/8"	30	2 to 5
SSLD309S	1-1/8"	30	2 to 5
SSLD419S	1-1/8"	41	2 to 5

CSLD SERIES COMPACT SUCTION LINE DRIERS



SOLDER ODF

Supco® P/N	Connection Size	Cubic Inches	Tonnage
CSLD1456	3/4"		
CSLD1457	7/8"	14	1/2 to 7
CSLD1459	1-1/8"		

DRIERS WITH UV DYE & MAGNETIC FILTERS



Supco® P/N Replaces
SUD8358 5303918288 & more



SPUN SERIES COPPER DRIERS



Supco® P/N	Supco® P/N
SUD103	SUD113
SUD109	SUD114
SUD110	SUD115
SUD111	SUD116
SUD112	

SPUN COPPER STRAINERS

Specifically Designed for Re-opened Systems. Each Strainer Contains an Oversized Screen Area for Filtering Large Quantities of burnt out Foreign Matter from System.

Supco® P/N	Inlet	Outlet	OAL	O.D.	Feed
S210	1/4"	.098 Cap Tube	2 3/4"	3/4"	1
S211	1/4"	.125 Cap Tube	2 3/4"	3/4"	1
S212	1/4"	1/4" Copper Tube	2 3/4"	3/4"	1
S214	3/8"	.125 Cap Tube	4 1/2"	5/8"	2
S215	3/8"	.125 Cap Tube	4 1/2"	5/8"	3
S216	3/8"	3/8" Copper Tube	4 1/2"	5/8"	1
S218	3/8"	.125 Cap Tube	4 1/2"	5/8"	1
S219	3/8"	.146 Cap Tube	5"	7/8"	4
S220	3/8"	.112 Cap Tube	4 1/2"	7/8"	6
MD5	1/4"	Cap	1"		



NEW!

SIGHT GLASSES & MOISTURE INDICATORS

Supco® P/N	Size	Description
SG118Z	1/4" x 1/4" sweat 7" long	Sight Glass
SG119Z	3/8" x 3/8" sweat 7 3/4" long	Sight Glass
SSGSS2Z	1/4" ODF	Moisture Indicator
SSGSS3Z	3/8" ODF	Moisture Indicator
SSGSS4Z	1/2" ODF	Moisture Indicator
SSGSS5Z	5/8" ODF	Moisture Indicator
SSGSS25Z	5/16" ODF	Moisture Indicator



Allin Liquid Eye®



DOT INDICATOR: Empty Full

ALLIN LIQUID EYE® SIGHT GLASSES

- Unique "See-Thru" feature that is more readable than other Sight Glasses
- Solid Brass Body
- Shock Resistant Glass
- Available in Flare or Solder
- Color Bar Designed for HFC Refrigerants



ALLIN LIQUID EYE® MOISTURE REACTORS

- Easy to Read in Minimal Light
- When Moisture is Present, the Color Bars on the Band within the Tube Change Color
- Solid Brass Body
- Shock Resistant Glass
- Available in Flare or Solder
- Color Bar Designed for HFC Refrigerants

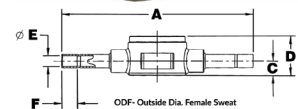

SSG SERIES MOISTURE INDICATOR

- 3% relative humidity sensitivity
- Maximum Working Pressure (MWP): 680 PSIG

VIBRATION ABSORBERS



Supco® P/N	Tube Size O.D.	Length	Max Working Pressure PSI
VAS-218	2 1/8"	20 1/2"	390
VAS-158	1 5/8"	16 3/4"	500
VAS-138	1 3/8"	15 1/2"	500
VAS-118	1 1/8"	13"	500
VAS-078	7/8"	11 7/8"	500
VAS-034	3/4"	10 1/2"	500
VAS-058	5/8"	9 3/4"	500
VAS-012	1/2"	8 7/8"	500
VAS-038	3/8"	8 1/2"	500

- Unique proven design for high pressure applications rated for R410A
- Compatible with all refrigerants
- Burst pressure 2500 (psig)
- 100% helium and hydrogen leak tested

WE OFFER OVER 340 SKUS OF V-BELT TYPES

All belts clearly identify RMA classic part number and dimensionally equivalent FHP number.

See the full offering at supco.com, search keyword "Belt"

MULTI-PLUS DUAL BRAND V-BELTS

3L SECTION FHP V BELTS

- 3/8" top width
- 7/32" thick

A SECTION CLASSICAL V BELTS

- 1/2" top width
- 11/32" thick
- Dual brand A & 4L

B SECTION CLASSICAL V BELTS

- 21/32" top width
- 13/32" thick
- Dual brand B & 5L



A1 & A2 ADJUSTABLE LINE TAP VALVES



Supco® P/N	Tube Size O.D.	Packaging
A1	1/4", 5/16", 3/8"	12/Box
A2	1/2", 5/8"	12/Box

BPV SERIES BULLET PIERCING VALVES

- *BPV21, BPV31 and BPV31D are furnished with adapters for indicated multiple applications



Supco® P/N	O.D. Tubing Size	Packaging
BPV31*	1/4", 5/16", 3/8"	12/Box
BPV31D*	1/4", 5/16", 3/8"	48/Box
BPV21*	1/2", 5/8"	8/Box
BPV14	1/4"	12/Box
BPV38	3/8"	12/Box
BPV34	3/4"	1/Box
BPV78	7/8"	1/Box

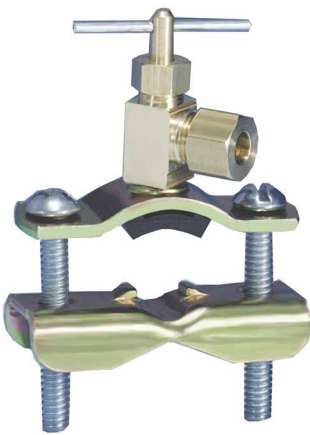

SELF-TAPPING WATER VALVE

- Fits 3/8" - 1 3/8" O.D. tubing or pipe

Supco® P/N
STV2LL

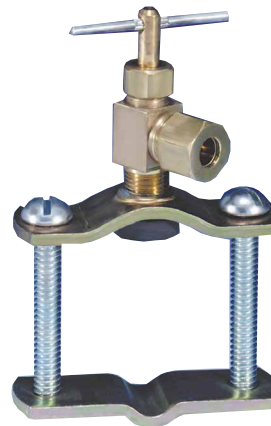

CONVENTIONAL "DRILL" TYPE VALVE

- Includes all fittings for 1/4" O.D. Copper and plastic tubing

Supco® P/N
STV2DLL

TAP VALVES

For humidifier & evaporative cooler installations.

- Lead Free
- NSF Certified
- 1/4" OD compression brass ball valve won't leak or clog

Supco® P/N	Description
TV78ODC	7/8" OD Compression Tap Valve
TV58ODC	5/8" OD Compression Tap Valve
TV34FSWT	3/4" Female Sweat Style Tap Valve
TV12FSWT	1/2" Female Sweat Style Tap Valve

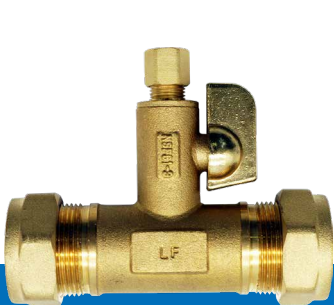

TV78ODC

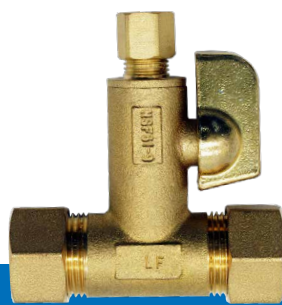

TV58ODC



TV34FSWT

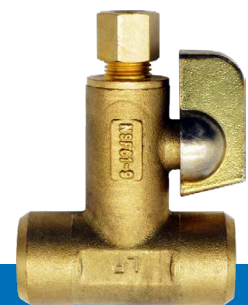

TV12FSWT

NEW!

DUAL VOLTAGE CONDENSATE TANK PUMP

Supco® P/N	Volts
SPCP24U	110 - 240

CONDENSATE MANAGEMENT



Suitable for ducted type units, floor standing and chassis type units and dehumidifiers, air handling units, refrigerated units, cold store.

- Dual voltage 110V to 240V
- Mold resistant tank
- Hall effect water level sensor
- 24ft Water lift capability
- Water overflow safety switch with audible alarm
- Maximum water temperature 140°F/60°C
- Built in wall mounting tabs on the tank
- Quiet operation - < 50db(A) at 3 feet
- Includes 19ft discharge tube and thermostat safety switch wire

INPUT VOLTAGE:	110 - 240
HZ	50/60
AMPS	1.2
WATTS	38

FLOW AT 1FT	138 GPH
MAX. LIFT	24"/7.3M
CERTIFICATE	ETL

DEFROST TIMERS

METAL CASE



- Heavy Duty, Synchronous Motor
- Time Initiated
- Temperature or Pressure Terminated
- 120VAC or 208-240VAC

PART NO.	INPUT	CONTACTS
S804100	120VAC, 60HZ	1 N.O. / 2 N.C. CONTACTS
S804120	208-240VAC, 60HZ	1 N.O. / 2 N.C. CONTACTS
S804500	120VAC, 60HZ	1 N.O. / 1 N.C. CONTACTS
S804520	208-240VAC, 60HZ	1 N.O. / 1 N.C. CONTACTS
S814100	120VAC, 60HZ	1 N.O. / 2 N.C. CONTACTS
S814120	208-240VAC, 60HZ	1 N.O. / 2 N.C. CONTACTS
S814500	120VAC, 60HZ	1 N.O. / 1 N.C. CONTACTS
S814520	208-240VAC, 60HZ	1 N.O. / 1 N.C. CONTACTS
S814521	208-240VAC, 50HZ	1 N.O. / 1 N.C. CONTACTS



Specifications

OPERATING VOLTAGES:	120 or 208/240 VAC, 60 Hz
CURRENT (AMPERAGE):	40 Amp non-inductive @ 120, 208 or 240 VAC
MAXIMUM HP:	2 hp @ 120, 208 or 240 VAC
PILOT DUTY:	690 VA @ 120, 208 or 240 VAC
OPERATING TEMPERATURE RANGE:	-35°F to +175°F (-37°C to +79°C)
OVERALL CASE DIMENSIONS:	7.697" H x 4.4" W x 3.8" D (19.6 cm H x 11.18 cm W x 9.66 cm D)
SHIPPING WEIGHT:	S8040 series 3.5 lbs (1.6 kgs) & S8141 series 3.75 lbs. (1.7 kgs)



MB14520

Exact drop in replacement mechanism for TORK® S814520 and Paragon® 8145-20. Available in 6-pack display.

MB14500

Exact drop in replacement mechanism for TORK® S814500, Paragon® 8145-00 & Precision® 6145-00



INDOOR
HEAVY DUTY
STEEL CASE

CONDENSATE MANAGEMENT



WALK-IN COOLERS/FREEZERS



COMMERCIAL REFRIGERATION SYSTEMS



EVAPORATORS

AMPERAGE	HP	PILOT DUTY	OPERATING TEMPERATURE	CASE DIMENSIONS	DEFROST INIATION	DEFROST TERMINATION
40-amp non-inductive @ 120-240VAC	2HP @ 120-240VAC	690VA @ 120-240VAC	-35 °F to 175 °F (-37°C to 79°C)	7.7" H x 4.4" W x 3.8" D	Time	Time



JONES® VALVE CONDENSATE CLEANOUT

- Most compact size on the market
- No cutting or repairing drain line
- Single Schrader allows for one hose hook-up
- 1/4" hose connection, 3/4" condensate line

Supco® P/N
JV1



DRAIN PLUS CONDENSATE DRAIN

- Eliminates "dry-trap" Syndrome
- Fits 3/4" drain lines

Supco® P/N
DP34

HOSE CLAMPS

- Made of 24 gauge stainless steel
- Uses an anodized steel hex screw



Supco® P/N	Description
CL4H	HOSE CLAMP 7/32" - 5/8"
CL6H	HOSE CLAMP 7/16" - 25/32"
CL8H	HOSE CLAMP 1/2" - 29/32"
CL10H	HOSE CLAMP 9/16" - 1 1/16"
CL12H	HOSE CLAMP 11/16" - 1 1/4"

Supco® P/N	Description
CL16H	HOSE CLAMP 13/16" - 1 1/2"
CL20H	HOSE CLAMP 13/16" - 1 3/4"
CL24H	HOSE CLAMP 1 1/16" - 2"
CL28H	HOSE CLAMP 1 5/16" - 2 1/4"
CL32H	HOSE CLAMP 1 9/16" - 2 1/2"

Supco® P/N	Description
CL36H	HOSE CLAMP 1 13/16" - 2 3/4"
CL48H	HOSE CLAMP 2 9/16" - 3 1/2"
CL72H	HOSE CLAMP 1 7/8" - 5"

CONDENSATE DRAIN HEATERS



- 7/16" Diameter Tip
- 18" leads cannot be cut, spliced, extended, or altered in any way.

Supco® P/N	Volts	Watts	Size	Leads
SH500	120	11	9"	18"
SH502	120	15	13"	18"
SH503	240	15	13"	18"
SH504	120	25	21"	18"
SH505	240	25	21"	18"



UNIVERSAL DRAIN HEATER

- 56" long leads cannot be cut, spliced, extended, or altered in any way
- Silicone construction
- These heaters are water resistant only, not water proof.

Supco® P/N	Volts	Watts
SH250	120	3



CONDENSATE PUMP DRAIN TUBING

- Vinyl drain tubing

Supco® P/N	Size
CPT3825	3/8 x 25'
CPT38100	3/8 x 100'

SLIMEOUT® CONDENSATE PAN CONDITIONING TABS



Supco® P/N	Description	Tablets/Jar
SO100	Slime Out	100
ST200	Slime Tab	200



WATER GUARD

- Powered by 9V battery (not included)
- Low battery indicator
- Alarms up to 72 hours
- Floating case
- Compact design, fits around appliances
- Powerful 90dB alarm
- Responds to direct contact with water

Supco® P/N
WG1



ELECTRONIC WATER OVERFLOW ALARM

- Shuts down system in the event of water leakage
- Use in conjunction with condensate pump as an additional safety mechanism
- LED indicators: Green: normal operation; Red: alarm condition
- Hermetically sealed, waterproof housing
- Supply Voltage: 18-30 VAC
- Max. Contact Current: 5A @ 24VAC
- Cable Length: 6 feet

Supco® P/N
WGW24

LINE DRIVER CO₂ DRAIN LINE GUN



Makes clearing clogged drain lines a breeze. Just load a cartridge, pull the trigger, and watch the line clear.

- Compact, portable design
- High pressure CO₂ cartridges deliver 800 PSI
- Flexible hose

Supco® P/N
DLG-1

LINE DRIVER CO₂ SMOOTH CARTRIDGES



ESP™ CO₂ cartridges pack a punch at a great price and are compatible with all industry drain line guns.

- Sold in packs of 12
- 12 Pack Threaded Cartridges Also Available

Supco® P/N	Description
CO2-12	12 Pack - Smooth
CO2-12T	12 Pack - Threaded



HVAC AIR-TRAP™

Residential / LIGHT Commercial Waterless Trap

Allows liquid condensate to drain from the HVAC equipment and simultaneously prevent air from entering or escaping from the equipment.

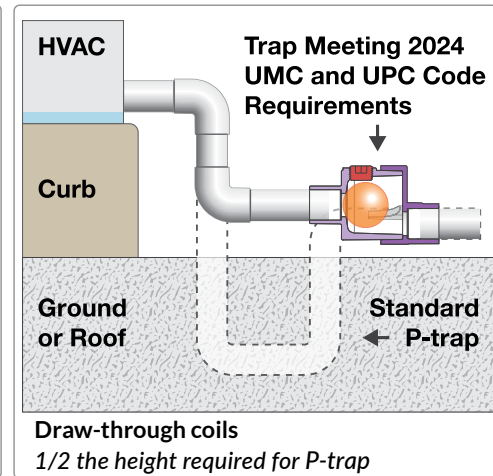
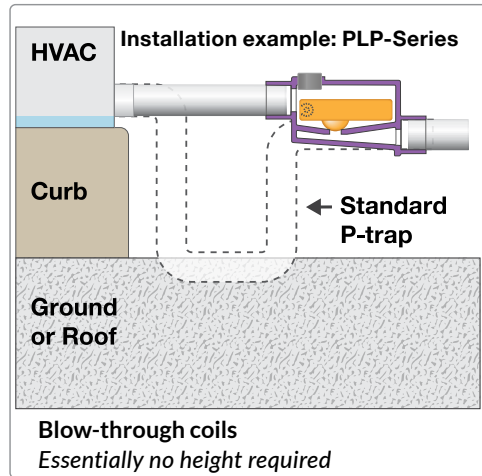

Air-Trap Series	Max Negative Pressure of WC (inches)	Max Positive Pressure of WC (inches)	Available Connection Sizes (inches)			Length (inches)
P	N/A	12	3/4	1	1-1/4 1-1/2	8
N	20	3	3/4	1	1-1/4 1-1/2	5.6
RLC	20	2.5	3/4	1 (with fitting)		4.65
FCN	5	0.5	3/4	1/2 (with fitting)		2.48
PLP-084	N/A	0 - 40	1-1/2	1-1/4 or 2 (with fitting)		7.75
PLP-051	N/A	0 - 6	3/4	1 (with fitting)		5.6
DMS	1	5/8	3/4 (25 mm)	5/8 ID Drain Hose		2.95
RLC-HF	20	N/A	1-1/4 & 1-1/2	2 (with fitting)		4.6

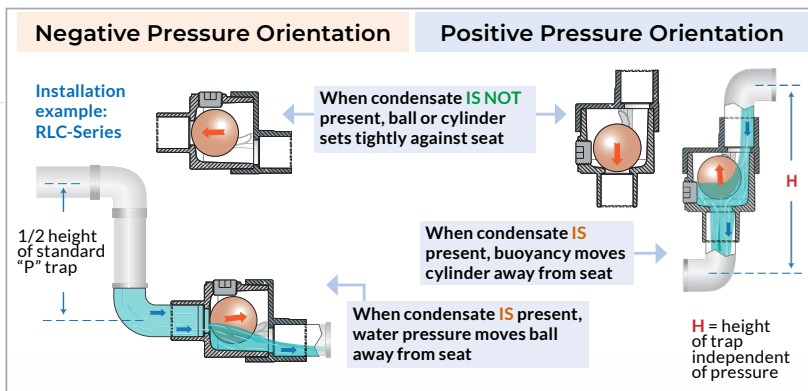

The HVAC Air-Trap™ not only solves P-trap height problems, but now enables you to meet code requirements and is ICC Certified.

ICC-ES EVALUATED



The Air-Trap™ concept has been incorporated into IAPMO IGC 196-2018 Standard for Condensate Traps and Overflow Switches for Air-Conditioning Systems.

N, P, RLC, FCN, RLC-HF, DMS & PLP-Series Air-Traps are Patented



Scan to download
the FREE Supco®
TechLink™ app to
easily document
system evacuations.



SUPCO® BLUETOOTH® VACUUM GAUGE

- Remote Bluetooth® monitoring from up to 200 ft. away
- Revolutionary contaminant and oil resistant Lifetime Sensor
- Record and export the evacuation process to PDF/Excel/CSV
- Includes vacuum coupler and convenient magnetic holding strap



DIGITAL VACUUM GAUGE

- Ultra Fine Resolution
- Easy-to-Clean LIFETIME Sensor Never Needs Replacing
- Reads Vacuum in 7 International Units
- Display Updates Every 1/2 Second
- Convenient Built in magnetic holding strap
- Low Battery Indicator
- Power Source: 3 AA Batteries (not included)
- Auto Shutoff

Supco® P/N	Description
VG640TL	SUPCO® Bluetooth® Vacuum Gauge
VG64	Digital Vacuum Gauge



LED MEGOHMMETER

The M500 provides fast and accurate measurements to verify the condition of the insulation.

- Zone scale to indicate insulation condition
- Measure insulation values up to 1000 megohms @ 500VAC
- Hand held
- Test leads store in case
- Operates on 2 C batteries (not included)
- Impact resistant
- Soft carrying case included

The Megohmmeter recommended by OEM for properly diagnosing inverter compressors & fan motors.

Supco® P/N
M500

VACUUM GAUGE COUPLER FOR ALL VACUUM GAUGES

- ¼" Female flare connections
- Brass construction

Supco® P/N
VGC





INVENTOR PROGRAM

Under the SUPCO TradeFox® Inventor Program, we work with technicians to bring their ideas to life and to the market through our years of experience in **engineering, manufacturing, marketing and national and global distribution.**

Visit SUPCOTRADEFOX.COM to learn more.



Supco® P/N

MUKIT

ADJUSTABLE MAGNETIC UMBRELLA KIT

- 60" wide
- Waterproof, UV-coated umbrella w/ durable and flexible fiberglass ribs
- Patented base swivels and locks
- Heavy-duty magnet attaches securely to any metal housing
- Includes NEW SUPCO TRADEFOX® Lanyard to secure the umbrella



JOSH COOLEY

SUPCO TRADEFOX® AND PRODUCT DEVELOPMENT MANAGER

Josh works directly with HVAC technician-inventors, who come to us through our Inventor Program, as well as with our engineering and manufacturing teams to add innovative new products under the SUPCO TradeFox® line. Josh understands technicians and the trade.

Not only does he have extensive hands-on experience in the HVACR field, having owned and operated a fifteen-truck HVAC Company in Phoenix and Nashville, but Josh is a SUPCO TradeFox® in his own right.

He is the inventor behind the SUPCO TradeFox® Magnetic Umbrella that so many Techs in our industry know and love. He has since invented the Fire Rated Magnetic Umbrella and accessories which allows other trades, such as line workers, the versatility to benefit from the patented adjustable umbrella system.

orders@supco.com

BRING MORE FLEXIBILITY TO YOUR SUPCO TRADEFOX® MAGNETIC UMBRELLA WITH THESE **ADD-ON ACCESSORIES.**



EXTENSION POLE FOR MAGNETIC UMBRELLA

- Adds 9" in height to umbrella (total height approx. 46")
- Easy installation - no tools required
- Attaches between umbrella and base
- Designed to use with MUKIT
- Intended to be used with MUKIT only when the umbrella is in vertical position

Supco® P/N

MUPOLE



SECURE CLAMP FOR MAGNETIC UMBRELLA

- Replaces magnetic base so umbrella can clamp to a variety of non-magnetic surfaces for more working flexibility
- Made from heavy-duty steel

Supco® P/N

MUCLAMP

NOW, EVEN MORE TRADE WORKERS CAN BENEFIT FROM THE VERSATILITY OF OUR **ADJUSTABLE UMBRELLA SYSTEM.**



KIT INCLUDES:

FIRE-RATED ADJUSTABLE MAGNETIC UMBRELLA KIT

Designed with NFPA 701 fire-rated fabric for a wide variety of applications.

Supco® P/N

MUKIT-FR



- 60" wide umbrella with NFPA 701 fire-rated fabric, fiberglass shaft and plastic ribs



- Patented, adjustable base swivels and locks
- Heavy-duty magnet to attach to any ferrous metal surface
- Lanyard to help secure umbrella



- Heavy-duty steel clamp

NEW!

JUMPER KING[®] 2.0

Multi-Jumper with Selector

**YOUR FAVORITE
MULTI-JUMPER UPGRADED:**

- NEW DURABLE ROCKER SWITCHES
- NOW INCLUDES 'L' SHAPED MAGNET TIPS
- NEW EASY-TO-SEE RED POPPER FUSE
- UPGRADED HOOK FOR VERTICAL HANGING
- UPGRADED JUMPER LEADS FOR DURABILITY
- NEW FRONT FACING LEAD PORTS FOR A MORE COMPACT UNIT



ROBERT KRAFT SUPCO TRADEFOX[®]

HVAC technician Robert Kraft wanted a safer way to start a unit, other than standard jumper wires, to minimize the risk of damaging a compressor. After many prototypes, he designed a versatile tool that can start the unit, bypass switches, and diagnose low voltage shorts with a 3 Amp pop-out fuse, and named it- rightly so, "The Jumper King".



Supco[®] P/N
TFXJK

UNIVERSAL PIPE LEVEL

This technician-invented clamp level takes the headache out of balancing levels on copper pipe or PVC. Just clamp it on and level up your HVAC and Plumbing game.

- Accurate and easy to level copper and PVC pipe sizes from 3/8" to 2"
- Clamp firmly attaches to the various pipe sizes for hands-free leveling
- Made from Durable ABS plastic that won't wear out quickly or become loose like typical pipe levels
- Easily clamps to your bag for quick access
- Use it everywhere. Clamp it or free set it to level duct work, air handlers, furnaces, drain pans, drain line pitch and so much more.

Supco[®] P/N
TFXUPL



MIKE FLYNN SUPCO TRADEFOX[®]

With an impressive Instagram following, HVAC technician Mike Flynn (@flynnstone1) is known for meticulously checking that pipes are plum and level. Push-on levels were always a challenge for him because the plastic gave way easily. It was also difficult and time-consuming to hold a drill and a level to the pipe, so he resorted to zip ties. Seeking a better way, Mike invented the clamp-on Universal Pipe Level as a versatile, hands-free option to save time and effort.



orders@supco.com

TRADEFOX[®] TECHNICIAN-INVENTED PRODUCTS

NEW!

COOLPRESSOR

High-Powered Magnetic Compressor Cooler

- **NEW!** Convenient valve for flow control at your fingertips
- Uses high powered magnet
- Saves time
- Creates a powerful cascade of water
- No messy backsplash
- Attaches to garden hose

Supco® P/N

CPPRO



EXTENDABLE FILTER BRACES

Holds filters in place to prevent them from being sucked into the return

- Extends from 16" - 31"
- Magnetic ends to hold in place
- Can use multiple braces for added support
- Sold in packs of 6



Supco® P/N

TFXEFB



RAY VALDEZ

SUPCO TRADEFOX®

HVAC technician Ray Valdez would often open a return filter grill to find the filter had been sucked up past the flanges. This was problematic because the air restriction could affect the efficiency of the A/C system, and cause other system issues. To fix the issue, he would have to struggle to run two pieces of metal plumbers tape across the area and screw the two ends to make a brace. This took a lot of trial and error and often looked bad. When one of his customers told him he got cut by the straps when changing the filter, Ray was determined to create a product that solved the problem. He invented the magnetic extendable filter braces to be quick, easy and safe.

Ray Valdez is also the inventor of the Magnetic Compressor Cooler.



NITROGEN PURGE BOOT

The Nitrogen Purge Boot was designed to assist the technician in the purging and brazing process. O-rings fit and seal over various sizes of ACR tubing creating a "hands-free" and hassle-free solution between your nitrogen regulator and the refrigerant line.

- Works on 3/8", 1/2", 5/8", 3/4", 7/8", and 1 1/8" OD ACR
- O-Rings are compatible with all refrigerant oils and flushing agents

Supco® P/N

TFXNPB

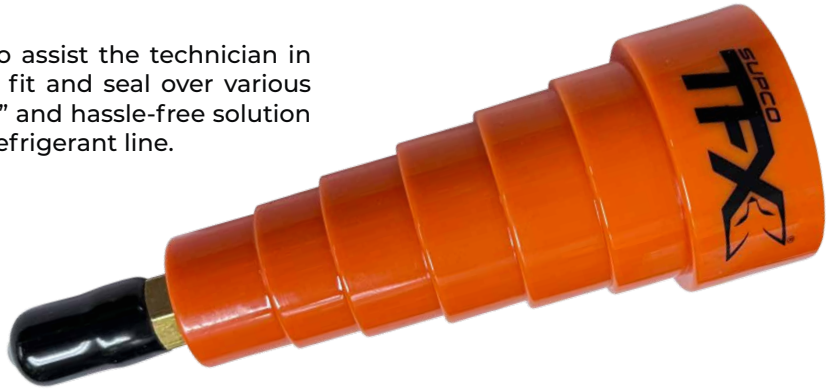

CHRIS HUGHES

SUPCO TRADEFOX®

The Nitrogen Purge Boot was invented by HVAC technician Chris Hughes after a challenging job scenario forced him and his crew to come up with makeshift solutions to push nitrogen through a large copper line set.

He walked away from the job with the idea for a hands-free tool that could easily pop on and pop off of line sets of various sizes with a flared end for hoses.



DISCONNECT MOUNTING PLATE

A universal way to secure the disconnect to the unit, without blocking access to the electrical panel.

- Designed to fit the various layouts of all single phase disconnect boxes using 1/2" length screws
- Cross pattern mounting design allows for universal installation on any caged or stamped condensing or packaged unit
- Uses hex nuts for easy installation with 5/16" nut driver
- Eliminates potential damage to the unit during installation
- Made of weather-resistant galvanized metal

Supco® P/N

TFXDMP

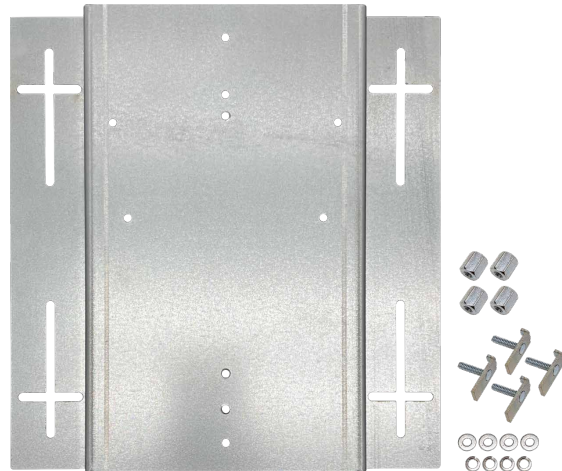

JUSTIN PETRY

SUPCO TRADEFOX®

The Disconnect Mounting Plate was invented by HVAC technician Justin Petry. Justin was inspired during a rooftop installation when he struggled to open the access panel because the disconnect was mounted directly to the door of a split system condenser. He came up with the idea of the mounting plate as a way to firmly and securely mount the disconnect when there is no other suitable mounting structure.

He also created it to help avoid some of the risky problems that can come from makeshift mounting fabrications which may damage a coil or block access to electrical panels.



UNIVERSAL ECM TESTER

- 24" wire length
- Short circuit protection
- 24 VAC operating voltage & indicating light
- Convenient magnet on back of unit
- No batteries required

Supco® P/N
ECMPRO

SUPCO TRADEFOX®: BRINGING TECHNICIANS' IDEAS TO LIFE

The ECMPRO was invented by an HVAC technician who was looking for a simple way to check if an Electronically Commutated Motor was good or bad in order to make a quicker diagnosis for the necessary repair.



ATTIC PRO® UTILITY LIFT

- Adjustable beam distance from 14" to 24"
- 20 ft. cable
- Lifts up to 250 lbs.

Supco® P/N
ATP1



STEVE SNYDER
SUPCO TRADEFOX®

The Attic PRO® was invented by Steve Snyder, an HVAC technician who was also a fireman. As a one-man operation, he was looking for a way to help lift furnaces and air handlers up into attics. One day on a training exercise, he used a winch to pull a person out of a man-hole - and the Attic PRO idea was born.



INCLUDES CARRYING CASE & STRAPS!

TIGHT TAPER® FOIL & MASTIC TAPE APPLICATOR

Supco® P/N
TT100

- Lightweight and durable applicator presses tape onto seams in tight spaces
- Non slip silicone ends help to easily release tape and smooth it evenly without tears or snags
- Applicator has both inches and cm for measuring tape length required



COIL CLEANING BRUSH

- Two tempered stainless steel cleaning heads built into a single unit
- Adjustable brush head pivots up to 120°
- Patented stiffness adjustment slide
- Handles extends to 4 ft.

Supco® P/N
CCB100



TUGBOAT COMPRESSOR TOTE

- Heavy-duty steel construction
- Can accommodate all types of compressors
- Adjustable grips
- Quick setup
- Breaks down for easy storage

Supco® P/N
TB100



WATER HEATER HANDLES

- Steel "T" shaped handles with 1" female steel threaded end
- Screws onto the inlet and outlet of water heater for secure gripping and carrying
- Includes 1" to 3/4" steel reducer
- Carrying strap acts as a bottom sling for an easier two person lift, especially on stairs

Supco® P/N
TFXWHH



POCKET CONTINUITY TESTER

- Visual light indicator
- Alarm indicator
- Alligator clips for handsfree use
- Magnet on case sticks to metal surfaces
- Shorter lead length eliminates tangling
- Uses one AAA battery

Supco® P/N
TFXCT



REFRIGERANT LINE CLEANING KIT

30 Foam Line Cleaners:

- (5) 1 3/8" (5) 7/8" (5) 5/8"
- (5) 1 1/8" (5) 3/4" (5) 1/2"

3 Launchers:

- (1) 1 3/8"
- (1) 7/8"
- (1) 5/8"

4 Adapters:

- (1) 1 3/8" - 1 1/8"
- (1) 7/8" - 3/4"
- (1) 5/8" - 1/2"
- (1) 5/8" - 3/8"

Supco® P/N
RLC100



INCLUDES CONVENIENT CARRYING CASE!

(1) Catch Net

NEW!

SAFETY LOCKING CAP COVERS

Color coded A2L, R22 and R410A covers.
Use with TRADEFOX® 1/4" and 5/16"
Safety Locking Caps.

/ NON-SLIP

/ NON-REMOVABLE

/ EASY IDENTIFICATION



Variety Packs
Includes (2) each: Locking Cap,
A2L, R22, and R410A Covers

Bulk Packs

Supco® P/N	Description
SFL14V	1/4" Locking Cap Cover Variety Pack
SFL516V	5/16" Locking Cap Cover Variety Pack

Supco® P/N	Description
LCCA2L10	10 PC A2L Safety Locking Cap Cover
LCCR2210	10 PC R22 Safety Locking Cap Cover
LCCR410A10	10 PC R410A Safety Locking Cap Cover

Supco® P/N	Description
LCCA2L50	50 PC A2L Safety Locking Cap Cover
LCCR2250	50 PC R22 Safety Locking Cap Cover
LCCR410A50	50 PC R410A Safety Locking Cap Cover

REFRIGERANT SAFETY LOCKING CAPS

Our SFL Series of Safety Locking Caps solves the hassles experienced with standard locking caps.

- No special tools required; uses a standard 3/16" hex key for removal
- Resists fat, grease, oils & solvents
- Compatible with R717, R12, R22, R134a, R404A, R410A and other refrigerants
- Code compliant for tamper resistance
- UV resistant thermoplastic
- Patented cam action cap that easily tightens by hand

Supco® P/N	Description
SFL1402	2 Pack 1/4"
SFL1410	10 Pack 1/4"
SFL1450	50 Pack 1/4"
SFL51602	2 Pack 5/16"
SFL51610	10 Pack 5/16"
SFL51650	50 Pack 5/16"



DRIP PAN HANGERS

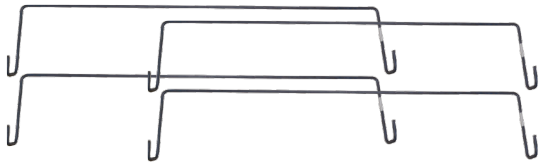

- Holds up to a 33" wide secondary safety pan
- 1/4" Epoxy Coated Steel Rod Construction
- Can be installed on Unistrut up to 1.75" wide
- To be used ONLY in conjunction with a secondary drain, NOT A SAFETY SWITCH
- Minimum 2 hangers used in standard installation
- 4pc/package

Supco® P/N
DPH33

FILTER PULLERS



- Makes getting hard to reach filters easy

Supco® P/N	Description
FP18	18" Extension
FP48	48" Extension

FUSE TESTING SUPER KIT

- (1) Standard Blade to 1/4" Fuse Adapter
- (1) Standard Blade to 5mm Fuse Adapter
- (1) Standard Blade to 4.5mm Fuse Adapter
- (1) Supco® Fuse Pro 3 AMP Tester with Light
- (1) Supco® Fuse Pro 5 AMP Tester with Light
- Auxiliary Wire Harness

Supco® P/N
BRKPRO



FUSE PRO BREAKERS



Supco® P/N	Description
BRK3	3 Amp Breaker
BRK5	5 Amp Breaker

- Two available sizes: 3 or 5 amp
- Plugs directly into PC boards
- Built in light for dark control board locations
- Eliminates wasted fuses

MAGNETIC TEST LEADS



Supco® P/N	Description
MAG1YL	Yellow Leads
MAG1BL	Blue Leads
MAG1BK	Black Leads
MAG1GR	Green Leads
MAG1RD	Red Leads

- Ideal for low voltage, 30V
- Powerful magnets
- 20" wire length



STEVE FISCHER SUPCO TRADEFOX®

The Magjumper™ was invented by Steve Fischer, an HVAC technician who wanted to find a way to keep alligator clips from popping off thermostat subbases. He taped magnets to alligator clips and his concept was born. Steve also invented the BRK3 and BRK5 Fuse PROs because he was wasting job time making trips to the gas station for fuses. He came up with the Fuse PRO to take the place of the fuse during low voltage circuit testing until the short is identified.

And, the extendable filter pullers? "I was tired of my clothes getting dirty reaching for filters." Steve said. "Plus, with the magnetic tip, it doubles as a magnetic reach tool." SUPCO manufactures Steve's filter pullers in 18" (FP18) and 48" (FP48) versions.

NEW!

LOCK BOX PRO

Key or Combination
Lock Thermostat Guard

- ✓ Can be opened with either built-in key or combination lock.
- ✓ Includes ring base, mounting screws, anchors and 2 keys.
- ✓ Strong, clear polycarbonate construction.
- ✓ Fits thermostats up to 7.25" W x 4.75" H x 2.25" D.



Supco® P/N
BTG-LBP

THERMOSTATS



THERMOSTAT GUARDS

Supco® P/N	Dimensions	Supco® P/N	Dimensions
BTG-UN	7.3" x 5.25" x 1.8"	BTG-DK	4 1/4" x 7 5/8" x 2 1/8"
BTG-K	5 1/4" x 4 3/8" x 3"	BTG-UM	8 1/4" x 5 3/8" x 3 1/2"
BTG-EK	3 7/8" x 3 1/2" x 2 1/2"	BTG-UWM	6 3/4" x 4 1/2" x 3 9/16"
BTG-RK	6 3/8" x 3 1/2" x 3"	BTG-54VL	6 1/4" x 4 1/4" x 3 1/8"
BTG-RWM	6 3/8" x 3 1/2" x 3 1/4"	BTG-54VLW	6" x 3 3/4" x 3 1/8"
BTG-UK2	8 1/4" x 5 3/8" x 3 1/2"		

AFFORDABLE THERMOSTATS
DESIGNED WITH CONTRACTORS IN MIND.

- 2 Heat / 2 Cool Heat Pump Systems
- System Powered w/ Battery Backup

MECHANICAL THERMOSTAT



Supco® P/N
43005A

- Heat / Cool
- Snap Action Switching
- Mercury Free



DIGITAL THERMOSTAT

- Non-Programmable
- Filter Change Indicator
- Indiglo Backlight

Supco® P/N
43054



5/2 DAY PROGRAMMABLE THERMOSTAT

- Pre-Programmed
- 4 Periods Per Day
- Indiglo Backlight

Supco® P/N
43154



IAQ FAN CYCLE TIMER

- Button selection for FAN ON cycle time in increments of 10, 20, 30 or 40 minutes per hour
- LEDs indicate when fan is running or in off-cycle
- Monitors the FAN ON green wire from the thermostat and runs the selected On/Off cycle as long as the thermostat does not call for heat/cool
- Provides a delay function when AC shuts off to prevent bringing excessive moisture from water condensation on the AC coil into the room

Supco® P/N
IAQ1040

SMOKE DETECTORS



SEE THE FULL LINE OF SYSTEM SENSOR® DETECTION AT SUPCO.COM

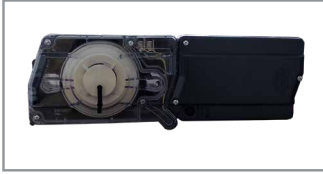

Photoelectric 4-Wire Duct Smoke Detector

Supco® P/N

DUCTSD



Photoelectric 4-Wire Duct Smoke Detector - 120V

Supco® P/N

D4120



Watertight Photoelectric 4-Wire Duct Smoke Detector

Supco® P/N

D4120W



Multi-Signaling Accessory with Add-on Strobe

Supco® P/N

RTS2-AOS

INNOVAIRFLEX® DUCT SAMPLING TUBES

Supco® P/N	Description	Supco® P/N	Description
DST1	Ducts up to 1 ft.	DST5	Ducts 4-8 ft.
DST1.5	Ducts 1.5 ft.	DST10	Ducts 8-12 ft.
DST2	Ducts to 2 ft.	DST22	Ducts 22 ft.
DST2.5	Ducts to 2.5 ft.	DST42	Ducts to 42 ft.
DST3	Ducts 2-4 ft.		



WHEN IAQ IS CRUCIAL, WE HAVE SOLUTIONS.



PCO

UUV-CBM-PCO
24VAC & 110 VAC

- ✓ 16" UV germicidal coil cleaner
- ✓ Improve energy efficiency
- ✓ Destroy mold & odors
- ✓ Various mounting scenarios
- ✓ Over/under voltage indicator
- ✓ LCD w/ real time status
- ✓ Countdown purifier animation
- ✓ Call-back indicator
- ✓ Photocatalytic Oxidation
- ✓ Captures volatile organic compounds



MASTER

UUV-CBM
24VAC & 110 VAC

- ✓ 16" UV germicidal coil cleaner
- ✓ Improve energy efficiency
- ✓ Destroy mold & odors
- ✓ Various mounting scenarios
- ✓ Over/under voltage indicator
- ✓ LCD w/ real time status
- ✓ Countdown purifier animation
- ✓ Call-back indicator
- Photocatalytic Oxidation
- Captures volatile organic compounds



ADVANCED

UUV-CBA
18-32V AC OR DC

- ✓ 16" UV germicidal coil cleaner
- ✓ Improve energy efficiency
- ✓ Destroy mold & odors
- ✓ Various mounting scenarios
- ✓ Over/under voltage indicator
- LCD w/ real time status
- Countdown purifier animation
- Call-back indicator
- Photocatalytic Oxidation
- Captures volatile organic compounds

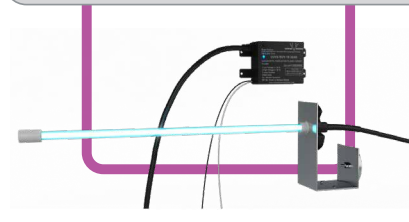

REPLACEMENT BULB FOR ALL MODELS

Supco® P/N
UUV-LP160T5

Will also replace other brands

LIFETIME BALLAST WARRANTY | 1-YEAR UV LAMP WARRANTY

Universal Solutions® Clear Blue® line of residential UV systems are distributed exclusively by SUPCO. These products are the smart answer to reduce bacteria, viruses and mold in the air and on the HVAC coil.

INDUSTRIAL BRUSHES

for HVAC and Refrigeration Installation and Service

This selection of general purpose and specialty brushes includes: Brushes for soldering and brazing preparation, cleaning boiler/furnace heat exchangers and burner assemblies, removing dust, dirt, and debris on condenser and evaporator coils for residential/commercial air conditioning and refrigeration equipment.

CONDENSER BRUSH



Supco® P/N	OAL	Pack QTY
BRS00408	30"	36

FIN WISK BRUSH



Supco® P/N	OAL	Filament	Pack QTY
BRS02026	6-1/2"	Polyester	24

FURNACE BRUSH



Supco® P/N	OAL	Filament	Pack QTY
BRS76200	48"	Crimped Brass	6
BRS76210	48"	Stainless Steel	12
BRS76220	48"	Grey Tampico	12

DOPE/ACID BRUSH



Supco® P/N	Description	OAL	Filament	Pack QTY
BRS10007	Dope/Acid Brush	7"	Horsehair	36
BRS10001	Acid Brush	6"	Horsehair	144*

*Sold per pack

CHIP BRUSH



Supco® P/N	OAL	Filament	Pack QTY
BRS67192	1"	White Natural Bristle	36
BRS67194	2"	White Natural Bristle	24
BRS67196	3"	White Natural Bristle	24

SCRATCH BRUSH



Supco® P/N	OAL	Filament	Pack QTY
BRS81002	7-3/4"	Stainless Steel	36

FITTING BRUSH



Supco® P/N	OAL	OD	ID	Pack QTY
BRS00924	5-3/4"	1/4"	1/8"	12
BRS00925	6-5/8"	3/8"	1/4"	12
BRS00926	6-5/8"	1/2"	3/8"	12
BRS00927	6-5/8"	5/8"	1/2"	12
BRS00928	6-5/8"	3/4"	5/8"	12
BRS00929	6-5/8"	7/8"	3/4"	12
BRS00931	6-5/8"	1-1/8"	1"	6
BRS00932	6-5/8"	1-3/8"	1-1/4"	6
BRS00934	6-5/8"	1-5/8"	1-1/2"	6
BRS00935	6-5/8"	2-1/8"	2"	6



INDUSTRIAL TUBE BRUSH

Supco® P/N	OAL	Filament	Pack QTY
BRS14518	15"	Nylon	12

BOILER BRUSH



Supco® P/N	OAL	Filament	Pack QTY
BRS46304	48"	Spring Grade Tempered Wire	12
BRS14477	30"	Natural Bristle	12
BRS14466	30"	Crimped Carbon Steel	12
BRS14468	46"	Crimped Carbon Steel	12

2-IN-1 BRUSH



Supco® P/N	OD	ID	Pack QTY
BRS009951	1/4"	1/8"	48
BRS009955	3/8"	1/4"	48
BRS009956	1/2"	3/8"	48
BRS009953	5/8"	1/2"	48
BRS009954	3/4"	5/8"	48
BRS009952	7/8"	3/4"	48

UTILITY WIRE BRUSH



Supco® P/N	OAL	Filament	Pack QTY
BRS81234	9.5"	Tempered Steel	12



SM600 SERIES EXACT REPLACEMENT & UTILITY MOTOR KITS

- SM675 is Thermally Protected
- SM675 Includes Fan Blade FB550 Only
- SM670, SM672, SM673 and SM690C Include Fan Blades FB402 and FB550
- Motor Kits Include Complete Hardware and Mounting Kits

Supco® P/N	Type	Volts AC	RPM	Shaft (in.)	Stack (in.)	Rotation (Reversible)
SM670	Sleeve	120	3000	3/16" x 1 1/4"	5/8"	CW/CCW
SM671	Sleeve	120	3000	3/16" x 1 1/4"	5/8"	CW/CCW
SM672	Sleeve	240	3000	3/16" x 1 1/4"	5/8"	CW/CCW
SM673	Sleeve	120	3000/1550	3/16" x 1 1/4"	5/8"	CW/CCW
SM675	Sleeve	120/240	3000	3/16" x 2 3/8"	1"	CW/CCW
SM690C	Sleeve	120	3000	3/16" x 1 1/4"	5/8"	CW/CCW

FAN HOOD MOTORS

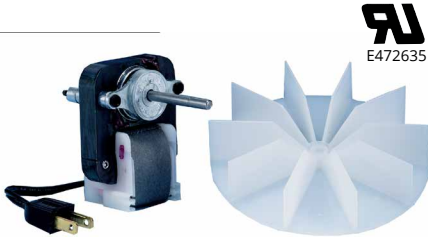

CAN REPLACE NUTONE® RANGE HOOD VENTILATORS

Supco® P/N	Volts	Speeds	RPM	Rotation	Shaft Diameter	Shaft Length
SM550	120	1	3000	CCW	7/32" Flat	1 3/4"
SM550P2*	120	1	3000	CCW	7/32" Flat	1 3/4"
SM551	120	2	3000/1640	CW	7/32" Flat	1 7/16"
SM552	120	1	3000	CCW	7/32" Flat	1 1/4"
SM553	120	1	3000	CCW	7/32" Flat	1 3/4"
SM554	120	2	3000/1500	CCW	7/32" Flat	1 7/16"
SM555	120	1	3000	CCW	7/32" Flat	2 3/8"

*2 Pack



MOTOR MOUNT BRACKET KIT

- Used with 5.5" motors
- Grommets and eyelets included
- For applications with 9" or 10" bolt circle diameters.

Supco® P/N	Description
MB55	3 leg
MB554	4 leg

ECONOMIC MOTOR PROTECTION

with full voltage range and adjustable imbalance.



UNIVERSAL THREE-PHASE MOTOR PROTECTOR

- Line Voltage: 180-600VAC
- Imbalance: Adjustable 4% to 20%
- Contact Type: SPDT 10A@240 VAC
- Short Cycle Adj: 10 Sec. to 5 Min.

Supco® P/N
TPMP1



THREE-PHASE MOTOR PROTECTOR

- Line Voltage: 208-277VAC
- Imbalance: Fixed 7%
- Contact Type: SPDT 5A@240 VAC

Supco® P/N
TPMP2

NEW!

HOT BLOCK POCKET BLOCK

- 4 oz of Hot Block material - Just enough to protect TXVs, and all heat sensitive areas.
- Fits in your back pocket.



Supco® P/N

SW-HBP

HOT BLOCK HEAT ABSORPTION PUTTY



As a 100% re-usable and non-toxic heat-absorbing putty, Hot Block will block direct and conductive heat transfer on all types of surfaces and metals, including joints, valves, fittings, composite panels, rubber, and plastics. Stops the transfer of heat up to 3000° F.

Supco® P/N

SW-HB1



BRAZING ROD SAVER

- Holds and dispenses brazing rods
- Keeps fingers safe from heat
- Get the most out of each rod - use it down to the last bit!
- Works with most brazing and soldering rods, round or flat
- Fits perfectly in Solderweld® Tech Repair Kits
- Made of lightweight aluminum
- Ergonomic design

Supco® P/N

SW-RS

FLAME RESISTANT MAGNETIC BLANKET



The SolderWeld® Magnetic Flame Resistant Blanket contains firm grip magnets, grommets, kevlar reinforced stitching and an opening slit so it can be easily snapped into place and removed during repairs.

Supco® P/N

SW-MFRB

ALUMINUM COIL TECH REPAIR KITS

Supco® P/N	Description
SW-ACRTB	Alum Coil Repair Tech Bag - Black
SW-ACRTC	Alum Coil Repair Tech Bag - Camo

ALUMINUM TO COPPER BRAZING

Supco® P/N	Description
SW-ALCU5.5	AL-COP Braze 8", 5 Rod Pack
SW-ALCU5K	AL-COP Braze 18", 5 Rod Pack

HVAC ALL-IN-ONE KITS & ACCESSORIES

Supco® P/N	Description
SW-HVAK05	5% Sil-Phos HVAC All-In-One Brazing Kit
SW-HVAK15	15% Sil-Phos HVAC All-In-One Brazing Kit
SW-STOBC	Rip & Grip Orange Canister Holder

ALUMINUM REPAIR

Supco® P/N	Description
SW-AS09305.5	Alloy SOL 8", 5 Rod Pack
SW-AS09305K	Alloy SOL 18", 5 Rod Pack HVAC Kit
SW-AS09310K	Alloy SOL 18", 10 Rod Pack Kit Top
SW-ASF1	Alloy SOL Flux™ White Aluminum Brazing and Soldering Flux
SW-ABFC05K	Alloy Braze Flux Cored Aluminum Repair 18", 5 Rod Pack

SILVER SOLDERS

Supco® P/N	Description
SW-SS05F1K	SIL SOL 5% Sil-Phos Flat, 1 lb.
SW-SS05F14K	SIL SOL 5% - Sil-Phos 1/2 lb Sleeve Flat
SW-SS15F1	SIL SOL 15% Sil-Phos Flat, 1 lb.
SW-SS1512K	SIL SOL 15% Sil-Phos 1/2 lb Sleeve Round
SW-SS5602K	SIL SOL 56% Flux Coated Round, 2 Rod Pack
SW-SS5610K	SIL SOL 56% Flux Coated Round, 10 Rod Pack

LOW TEMP DISSIMILAR METAL SOLDER

Supco® P/N	Description
SW-MS09305K	Multi SOL 18", 5 Rod Pack
SW-MSF2	Multi SOL FLUX .7oz



350°, 20,000 PSI RATING

NEW!

DURO DYNE[®] **Duro-Line**[™] STEEL LINE SETS



Duro-Line was designed and developed to MIMIC copper, creating the perfect replacement for copper line sets. Duro-Line's **patented technology** creates the perfect balance of strength and flexibility, coupled with superior roundness that holds its shape, even when cut. This Low Carbon Steel Line Set has built-in corrosion and chemical resistance that is unmatched in the industry. This time-tested technology is why Duro-Line is the better line set.

- Duro-Line's coated low-carbon steel tubing has proven use in the Refrigeration and Automotive industry for over 40 years.
- Proudly Made in USA
- 20-year warranty on the tubing; 5-year warranty on the insulation
- Outstanding Flexibility – Makes routing and installation faster and easier.
- Superior Roundness and Consistency – Ensures smooth refrigerant flow and secure connections.
- Practical – Use all your original tools, no need for special tools.
- Sustainable Strength – Duro-Line is more durable and less susceptible to puncture or penetration.



PART NO.	DESCRIPTION	PART NO.	DESCRIPTION
SLS1451625	1/4 LL, 5/16 SL X 25' W/Insulation	SLS385825	3/8 LL, 5/8 SL X 25' W/Insulation
SLS1451650	1/4 LL, 5/16 SL X 50' W/Insulation	SLS385835	3/8 LL, 5/8 SL X 35' W/Insulation
SLS143815	1/4 LL, 3/8 SL X 15' W/Insulation	SLS385850	3/8 LL, 5/8 SL X 50' W/Insulation
SLS143825	1/4 LL, 3/8 SL X 25' W/Insulation	SLS383425	3/8 LL, 3/4 SL X 25' W/Insulation
SLS143850	1/4 LL, 3/8 SL X 50' W/Insulation	SLS383435	3/8 LL, 3/4 SL X 35' W/Insulation
SLS141215	1/4 LL, 1/2 SL X 15' W/Insulation	SLS383450	3/8 LL, 3/4 SL X 50' W/Insulation
SLS141225	1/4 LL, 1/2 SL X 25' W/Insulation	SLS387825	3/8 LL, 7/8 SL X 25' W/Insulation
SLS141250	1/4 LL, 1/2 SL X 50' W/Insulation	SLS387835	3/8 LL, 7/8 SL X 35' W/Insulation
SLS5165830	5/16 LL, 5/8 SL X 30' W/Insulation	SLS387850	3/8 LL, 7/8 SL X 50' W/Insulation
SLS5165850	5/16 LL, 5/8 SL X 50' W/Insulation	SLS1450U	1/4 Uninsulated Line Set 50'
SLS5163725	5/16 LL, 3/4 SL X 25' W/Insulation	SLS51650U	5/16 Uninsulated Line Set 50'
SLS5163430	5/16 LL, 3/4 SL X 30' W/Insulation	SLS3850U	3/8 Uninsulated Line Set 50'
SLS5163450	5/16 LL, 3/4 SL X 50' W/Insulation	SLS1250U	1/2 Uninsulated Line Set 50'
SLS5167825	5/16 LL, 7/8 SL X 25' W/Insulation	SLS5850U	5/8 Uninsulated Line Set 50'
SLS5167830	5/16 LL, 7/8 SL X 30' W/Insulation	SLS3450U	3/4 Uninsulated Line Set 50'
SLS5167850	5/16 LL, 7/8 SL X 50' W/Insulation	SLS7850U	7/8 Uninsulated Line Set 50'

Other combinations and sizes available by request, including single lines and uninsulated straights and coils.

DURO-LINE[™] STEEL LINE SETS

PIPE VISE™

PIPEVISE.COM

PREMIUM PIPE TOOLS FOR PROFESSIONALS

8 - 19mm Nut Capacity
Self-Adjusting Micro Wrench

SUPCO® P/N: SW127-14



MICRO 5

1.5" Cap. Portable
Steel Pipe Vise

SUPCO® P/N: PV01



BIGFOOT

1.5" Cap. Portable
Alum. Pipe Vise

SUPCO® P/N: APV01



BIGFOOT ULTRALIGHT

2" Cap. Portable
Alum. Pipe Vise

SUPCO® P/N: APV02



ROUGHNECK

1" Cap. Self Adjusting
Alum. Pipe Wrench

SUPCO® P/N: ASW7-1



AMIGO

1" Capacity Self-Adjusting
Steel Pipe Wrench

SUPCO® P/N: SW12-1S



AMIGO SLIM

8 - 19mm Nut Capacity
Extended Reach Self-
Adjusting Micro Wrench

SUPCO® P/N: SW254-14



MICRO 10

Micro Stubby
with Bit Driver

SUPCO® P/N: SW72-19



NEW!

MICRO STUBBY

6-13 MM Nut Capacity
Micro Mini Wrench

SUPCO® P/N: SW78-13



NEW!

MICRO MINI

TR1 Tool Roll (tools included)

SUPCO® P/N: TR1-CY-KIT



NEW!

SUPCO® P/N	ITEM DESCRIPTION
PV02	BOSS 2" Capacity Portable Steel Pipe Vise
MV02	BOSS MOUNTABLE 2" Capacity Mountable Steel Pipe Vise
MV05	BIG BOY MOUNTABLE 5" Capacity Mountable Steel Pipe Vise
APV05	BIG BOY 5" Capacity Heavy Duty Portable Aluminum Pipe Vise
ASW24-3	THOR 3" Capacity Heavy Duty Self Adjusting Aluminum Pipe Wrench
APW14	14" Aluminum Pipe Wrench
OAPW14	14" Aluminum Offset Pipe Wrench
SW7-1	AMIGO STEEL 1" Capacity Compact Self-Adjusting Pipe Wrench
SW16-1	AMIGO XL 1" Capacity Extended Leverage Self-Adjusting Steel Pipe Wrench
BWS-1	Basin Wrench Socket
WPP10	10" Slim Jaw Pliers
14CF-19	MICRO CROWFOOT Socket 8-19MM
TR1-CY	TR1 Tool Roll (tools not included)
PVB-GO	Pipe Vise Go Bag
DM1819-CY	Drop Mat (tools not included)
P-CY-SW7-1S	Amigo Slim Pouch (tools not included)
HOL-SW127-COY	MICRO 5 POUCH (tools not included)
HOL-SW254-COY	MICRO 10 POUCH (tools not included)
HOL-SW127-254-COY	MICRO 5 AND 10 COMBO POUCH (tools not included)
P-CY-SW72-19	MICRO STUBBY POUCH (tools not included)
PVS1	METAL PIPE THREAD SEALANT



NEW: PUSH-TO-CONNECT REFRIGERANT FITTINGS. FLAME-FREE. TOOL-FREE. PROBLEM-FREE.



SBC14



SBE38



SBE4512



SBF12



SBCR3814



SBER3814



1/4" - 7/8" Couplers • Flares • Elbows • Reducers

MODEL NAME	NOMINAL SIZE	CONNECTION		LENGTH	OUTER DIAMETER		CONNECTION	
		ØA (INCH)	B (INCH)		(HEX)	THREAD		
				ØA (INCH)	B (INCH)	ØC (INCH)	D (INCH)	
COUPLINGS								
SBC14	1/4"	0.250	1.890	1.890	0.787		NONE	
SBC38	3/8"	0.375	1.969	1.969	0.945			
SBC12	1/2"	0.500	2.126	2.126	1.063			
SBC58	5/8"	0.625	2.244	2.244	1.181			
SBC34	3/4"	0.750	2.579	2.579	1.457			
SBC78	7/8"	0.875	2.618	2.618	1.575			
90° ELBOWS								
SBE14	1/4"	0.250	1.161	1.161	0.787		NONE	
SBE38	3/8"	0.375	1.260	1.260	0.945			
SBE12	1/2"	0.500	1.417	1.417	1.063			
SBE58	5/8"	0.625	1.535	1.535	1.181			
SBE34	3/4"	0.750	1.732	1.732	1.457			
SBE78	7/8"	0.875	1.772	1.772	1.575			
45° ELBOWS								
SBE4514	1/4"	0.250	1.024	1.024	-		7/16-20 UNF	
SBE4538	3/8"	0.375	1.181	1.181	-		5/8-18 UNF	
SBE4512	1/2"	0.500	1.339	1.339	-		3/4-16 UNF	
SBE4558	5/8"	0.625	1.398	1.398	-		7/8-14 UNF	
FLARES								
SBF14	1/4"	0.250	1.516	1.516	0.669		7/16-20 UNF	
SBF38	3/8"	0.375	1.634	1.634	0.866		5/8-18 UNF	
SBF12	1/2"	0.500	1.831	1.831	0.945		3/4-16 UNF	
SBF58	5/8"	0.625	2.087	2.087	1.063		7/8-14 UNF	
MODEL NAME	NOMINAL SIZE	CONNECTION PIPE			LENGTH			
		ØA (INCH)	B (INCH)	ØC (INCH)	D (INCH)			
REDUCER COUPLINGS								
SBCR3814	1/4"x3/8"	0.250	0.375	1.969		-		
SBCR1238	3/8"x1/2"	0.375	0.500	2.165		-		
SBCR5812	1/2"x5/8"	0.500	0.625	2.362		-		
REDUCER ELBOWS								
SBER3814	1/4"x3/8"	0.250	0.375	1.024		1.181		
SBER1238	3/8"x1/2"	0.375	0.500	1.181		1.339		
SBER5812	1/2"x5/8"	0.500	0.625	1.339		1.398		

SBI® PUSH-TO-CONNECT REFRIGERANT FITTINGS

Line Markers & Disconnect Clips

SBLM1458



Line Marker 1/4"-5/8"

SBDC1458



Disconnect Clips 1/4"-5/8"

SBLMDC3478



Line Marker/Disconnect Clips 3/4"-7/8"



@sealedunitpartsco | @supco_hvac | supco.com
P: 800.333.9125 | E: orders@supco.com | F: 800.458.2818

Copyright © 2026 Sealed Unit Parts Co., Inc. All rights reserved.