



**WATER
REFILL
GROUP**
SUSTAINABLE HYDRATION

Drinking Solutions for Every Application

Our drinking water products are designed to meet or exceed your needs and specifications. We have a wide variety of bottle filling stations and water coolers that comply with adult or child ADA standards, as well as models that offer the added assurance of our WaterSentry® filters.

We offer products for any space and industry, indoors and outdoors:

- 
EDUCATIONAL INSTITUTIONS
- 
FACTORIES AND WAREHOUSES
- 
HEALTHCARE
- 
HOTEL
HOSPITALITY ENVIRONMENTS
- 
GYM
INDOOR FITNESS CENTERS
- 
OFFICE BUILDINGS
- 
PARKS AND RECREATION AREAS
- 
RESIDENTIAL
- 
TRANSPORTATION STATIONS



HYDRATION WHERE IT'S NEEDED MOST

From workplaces to schools and public buildings, we supply hygienic, sustainable bottle filling stations designed to reduce plastic waste and improve access to clean drinking water.

Top Products

1
Vending Rooms



LBWD2C00BKC

2
Outdoor



LK4420BF1UEVG

3
Pool Area



LK4400BFVWGWR

4
Fitness Center



LZS8WSL2K

5
Hallways



LZWSSMJO

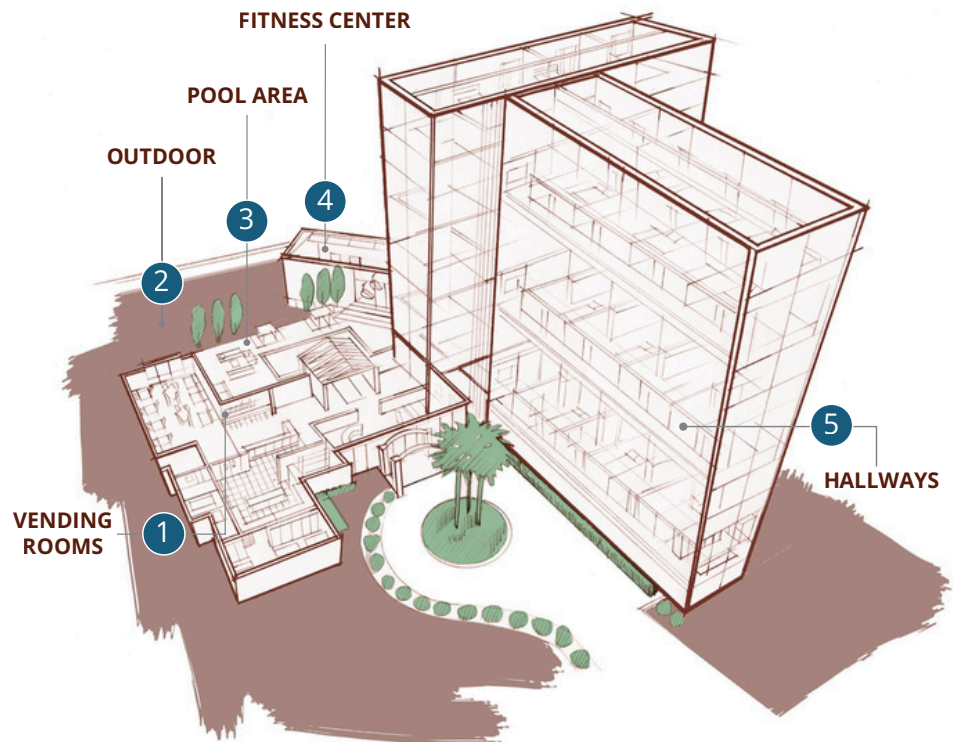

OUR VISION

We're building a refill culture that leaves single-use plastics behind. That means practical, durable water stations where people live, learn, work and play, backed by expert advice, nationwide delivery, and long-term support.

Whether you're installing one unit in a school hallway or rolling out a network across a major transport hub, we're here to make it easy, and impactful.



ezH2O® Bottle Filling Stations

ezH2O® units have great features to provide convenient, sustainable and healthy hydration.



Hands Free

Sensor activation and bottle rest platform provide users with a touchless bottle filling experience.



Minimal Splashing

Dispenses a clean, laminar flow of water so there's minimal splashing.



Filter Status Lights

Colourful lights indicate when filter needs changing so you always know you're getting filtered water.



Antimicrobial Protection

Inhibits the growth of mold and mildew.



Real Drain

The basin includes a real drain system to help with drainage and eliminate standing water.



Quick Fill and Laminar Flow

Fill rate is 4.1 LPM for refrigerated units and 5.7 LPM for non-refrigerated units.



Green Ticker™

Informs users of the number of 590 ml single-use water bottles saved from waste by using reusable bottle and cups.

Features vary by model.

Elkay EZH2O® Hands Free Bottle Filling Station



- **Bubbler:** Flexi-Guard® safety bubbler provides a flexible mouth guard to protect against injury
- **Activation:** Touchless sensor activation for bottle filling and push-bar activation for the drinking fountain
- **Filter:** WaterSentry® Plus 3000 gallon / 11 356 L filter certified to NSF/ANSI 42 & 53 for lead, particulates, chlorine, taste & odour reduction, with visual filter monitor light
- **Green Counter™:** Backlit LED counter showing number of single-use bottles saved
- **Location:** Rated for indoor service
- **Installation:** Wall-mount
- **Quick Fill Rate:** 1.1 to 1.5 GPH
- **Power:** 220–240 V / 50–60 Hz
- **Dimensions (in):** (L) 18-3/8" × (W) 19" × (H) 39-1/16"
- **Dimensions (mm):** (L) 467 × (W) 483 × (H) 993



MODEL	MATERIAL cabinet	FINISH cabinet	FILTER	REFRIGERATION	SHIPPING WEIGHT
LZO8WSS2KN	Stainless Steel	Stainless Steel	✓	Refrigerated (8 GPH / 30 LPH)	81 lbs (36.7 kg)

Elkay Pro Filtration® Bottle Filling Station



- **Bubbler:** Flexi-Guard® safety bubbler provides a flexible mouth guard to protect against injury
- **Activation:** Electronic Bottle Filler Sensor with Electronic Front and Side Bubbler Pushbar
- **Filter:** Ultra-capacity filtration system certified to NSF/ANSI 42, 53 & 401 for lead, microplastics and more
- **Green Counter™:** Backlit LED counter showing number of single-use bottles saved
- **Location:** Rated for indoor service
- **Installation:** Wall-mount
- **Quick Fill Rate:** 1.1 to 8 GPH
- **Power:** 115V / 60Hz
- **Dimensions (in):** (L) 18-3/8" x (W) 19" x (H) 46-7/8"
- **Dimensions (mm):** (L) 482.6 × (W) 466.73 × (H) 1190.63



MODEL	MATERIAL cabinet	FINISH cabinet	FILTE R	REFRIGERATION	SHIPPING WEIGHT
LZS8WSBPRO	Stainless Steel	Black Stainless	✓	Refrigerated (chilled bottle filler + cooler)	79 lbs (36 kg)

Refill Hub - Touch Free Refill Station

- **Activation:** Electronic bottle filler sensor
- **Filter:** WaterSentry® Plus 3000 gallon / 11 356 L filter certified to NSF/ANSI 42 & 53 for lead, particulates, chlorine, taste & odour reduction, with visual filter monitor light
- **Location:** Rated for indoor service
- **Installation:** Wall-mount
- **Power:** 230V / 50Hz
- **Dimensions (in):** (L) 11.80" × (W) 24" × (H) 59"
- **Dimensions (mm):** (L) 300 × (W) 600 × (H) 1500



MODEL	MATERIAL cabinet	FINISH cabinet	FILTER	REFRIGERATION	SHIPPING WEIGHT
HTHB8-WF	Stainless Steel	Stainless Steel / branded option	-	-	84 lbs (38 kg)

Refill Stream - Eco-Dispenser

- **Activation:** Electronic bottle filler sensor
- **Filter:** WaterSentry® Plus 3000 gallon / 11 356 L filter certified to NSF/ANSI 42 & 53 for lead, particulates, chlorine, taste & odour reduction, with visual filter monitor light.
- **Location:** Rated for indoor service.
- **Green Counter™:** Digital counter displays number of single-use bottles saved.
- **Installation:** Wall-mount (in-wall frame/plate)
- **Power:** 230V / 50Hz.
- **Dimensions (in):** (L) 19-3/4" x (W) 3-1/2" x (H) 40-13/16"
- **Dimensions (mm):** (L) 610 × (W) 309 × (H) 1696



MODEL	MATERIAL cabinet	FINISH cabinet	FILTER	REFRIGERATION	SHIPPING WEIGHT
HTHB-WF	Stainless Steel	Stainless Steel / branded option	✓	-	79 lbs (36 kg)

Elkay EZH2O® Bottle Filling Station with Versatile Bi-Level ADA Cooler



- **Bubbler:** Flexi-Guard® safety bubbler provides a flexible mouth guard to protect against injury.
- **Activation:** Electronic Bottle Filler Sensor & Sensor Bubbler
- **Filter:** WaterSentry® Plus 3000 gallon / 11 356 L filter certified to NSF/ANSI 42 & 53 for lead, particulates, chlorine, taste & odour reduction, with visual filter monitor light.
- **Green Counter™:** Tracks number of single-use plastic bottles saved.
- **Location:** Rated for indoor service.
- **Installation:** Wall-mount
- **Quick Fill Rate:** 1.1 to 1.5 GPH
- **Power:** 220–240 V / 50–60 Hz.
- **Dimensions (in):** (L) 36-3/4" x (W) 19" x (H) 39-1/16"
- **Dimensions (mm):** (L) 485 × (W) 930 × (H) 930



MODEL	MATERIAL cabinet	FINISH cabinet	FILTER	REFRIGERATION	SHIPPING WEIGHT
LZOOTL8WSS2KN	Stainless Steel	Stainless Steel	✓	Refrigerated (8 GPH / 30 LPH)	106 lbs (48kg)

Halsey Taylor - Non-Refrigerated Drinking Fountain with HydroBoost Bottle Filler



- **Bubbler:** Double Bubbler™
- **Activation:** Electronic Bottle Filler Sensor With Mechanical Front Bubbler Button
- **Filter:** Filtered unit certified to reduce lead, particulates, taste and odour
- **Green Counter™:** Tracks number of single-use plastic bottles saved
- **Location:** Rated for indoor service
- **Installation:** Wall-mount
- **Power:** 115V / 60Hz
- **Dimensions (in):** (L) 19-3/4" x (W) 19" x (H) 34-5/8"
- **Dimensions (mm):** (L) 440 × (W) 500 × (H) 880



MODEL	MATERIAL cabinet	FINISH cabinet	FILTER	REFRIGERATION	SHIPPING WEIGHT
HTHBWF-OVLEBP-I	Stainless Steel	Stainless Steel	✓	-	103 lbs (54kg)

Elkay EZH2O® Bottle Filling Station with Single ADA Cooler



- **Bubbler:** Combination unit includes sensor-activated bottle filler and mechanical push-bar bubbler for the cooler
- **Activation:** Mechanical Front and Side Bubbler Pushbar
- **Filter:** WaterSentry® Plus 3000-gallon filter certified to NSF/ANSI 42 & 53 for lead, particulates, taste/odor reduction
- **Green Counter™:** Digital counter displays number of single-use bottles saved
- **Location:** Rated for indoor service
- **Installation:** Wall-mount
- **Quick Fill Rate:** 8.0 GPH
- **Power:** 115V / 60Hz
- **Dimensions (in):** (L) 18-1/16" x (W) 18-5/8" x (H) 20-11/16"
- **Dimensions (mm):** (L) 470 × (W) 460 × (H) 525



MODEL	MATERIAL cabinet	FINISH cabinet	FILTER	REFRIGERATION	SHIPPING WEIGHT
LMABF8WSS2KN	Stainless Steel	Stainless Steel	✓	Refrigerated (8 GPH / 30 LPH)	40 lbs (18kg)

HydroBoost® Bottle Filling Station & Bi-Level Integral Contour™



- **Bubbler:** Double Bubbler™
- **Activation:** Electronic Bottle Filler Button with Mechanical Front Bubbler Button
- **Filter:** Filter module certified to reduce lead, particulates, taste & odour
- **Green Counter™:** Digital counter displays number of single-use bottles saved
- **Location:** Rated for indoor service
- **Installation:** Wall-mount
- **Power:** 115V / 60Hz
- **Dimensions (in):** (L) 38-1/2" x (W) 19-3/8" x (H) 34-5/8"
- **Dimensions (mm):** (L) 980 × (W) 510 × (H) 880



MODEL	MATERIAL cabinet	FINISH cabinet	FILTER	REFRIGERATION	SHIPPING WEIGHT
HTHBWF-OVLSEBP-I	Stainless Steel	Stainless Steel	✓	-	123 lbs (56kg)

Halsey Taylor - Wall Mounted HydroBoost Bottle Filler And Drinking Fountain



- **Dual-Function:** Complete cooler and bottle filling station in a consolidated space saving ADA compliant design
- **Activation:** Electronic Bottle Filler Sensor With Mechanical Front And Side Bubbler Pushbar
- **Filter:** Optional WaterSentry Plus 3000 gallon/11,356 litre filter (certified to NSF 42 and 53 for lead, particulate, chlorine, taste and odour reduction) with Visual LED Filter Monitor to indicate when replacement is necessary
- **Bubbler:** Double Bubbler™
- **Green Counter™:** Counts the quality of bottles saved from waste
- **Location:** Rated for indoor service
- **Installation:** Wall-mount
- **Quick fill rate:** 1.1-1.5 GPM / 4.2-5.7 LPM
- **Power:** 230V/50Hz
- **Dimensions (in):** (L) 17-7/8" x (W) 18-1/2" x (H) 39-3/4"
- **Dimensions (mm):** (L) 470 × (W) 450 × (H) 980



MODEL	MATERIAL cabinet	FINISH cabinet	FILTER	REFRIGERATION	SHIPPING WEIGHT
HTHB-HAC8SS-WF	Stainless Steel	Stainless Steel	✓	Refrigerated (8 GPH / 30 LPH)	89 lbs (40 kg)

Elkay EZH2O® Mechanical Surface Mount with Visual Monitor



- **Activation:** Mechanical Bottle Filler Button
- **Filter:** 500 gallon / 1,893 litre capacity AquaSentry filtration with battery powered Visual LED Filter Monitor to indicate when replacement is necessary
- **Green Counter™:** Counts the quality of bottles saved from waste
- **ADA:** Meets ADA standards when properly installed
- **Location:** Rated for indoor/outdoor service
- **Installation:** Wall-mount
- **Quick fill rate:** 1.1-1.5 GPM / 4.2-5.7 LPM
- **Dimensions (in):** (L) 17-7/8" x (W) 6-1/4" x (H) 25-7/8"
- **Dimensions (mm):** (L) 305 x (W) 560 x (H) 760



MODEL	MATERIAL cabinet	FINISH cabinet	FILTER	REFRIGERATION	SHIPPING WEIGHT
EMASMB	Stainless Steel	Stainless Steel	Optional	-	22 lbs (10 kg)

Elkay EZH2O® Bottle Filling Station Surface Mount



- **Activation:** Electronic Bottle Filler Sensor
- **Green Counter™:** Digital counter displays number of single-use bottles saved.
- **Location:** Rated for indoor service.
- **ADA:** Meets ADA standards when properly installed
- **Installation:** Wall-mount
- **Power:** 220V / 50-60Hz
- **Dimensions (in):** (L) 17-15/16" x (W) 8-3/16" x (H) 25-7/16"
- **Dimensions (mm):** (L) 200 × (W) 430 × (H) 635



MODEL	MATERIAL cabinet	FINISH cabinet	FILTER	REFRIGERATION	SHIPPING WEIGHT
EZWSSMJO	Stainless Steel	Stainless Steel	-	-	32 lbs (16kg)

Elkay EZH2O® Filtered Bottle Filling Station Surface Mount



- **Filter:** WaterSentry® Plus 3000 gallon (11,356 L) filter certified to NSF/ANSI 42 & 53 for lead, particulates, taste and odour reduction.
- **Activation:** Electronic Bottle Filler Sensor
- **Green Counter™:** Digital counter displays number of single-use bottles saved
- **ADA:** Meets ADA standards when properly installed
- **Location:** Rated for indoor service.
- **Installation:** Wall-mount
- **Power:** 220V / 50-60Hz
- **Dimensions (in):** (L) 17-15/16" x (W) 8-3/16" x (H) 25-7/16"
- **Dimensions (mm):** (L) 92.17 × (W) 203.2 × (H) 635



MODEL	MATERIAL cabinet	FINISH cabinet	FILTER	REFRIGERATION	SHIPPING WEIGHT
LZWSSMJO	Stainless Steel	Stainless Steel	✓	-	35 lbs (16kg)

Outdoor Tubular Bottle Filling Stations and Fountains

Our outdoor tubular bottle filling stations and drinking fountains offer attractive, long-lasting durability to withstand tough weather conditions. The strong exterior is made from Type 316 stainless steel — standard on all Elkay outdoor tubular models. They are built for busy areas such as parks, pools, golf courses, and school and work campuses.

Vandal Resistant

Vandal-resistant push buttons, bubblers and screws.

Sealed Freeze Resistance

Freeze-resistant models feature completely enclosed and sealed valves to keep water safe from contamination.

Quick Fill and Laminar Flow

Fill rate is 3.8 LPM. Fills bottles faster than a standard drinking fountain. Laminar flow produces a clean fill with minimal splash.

Type 316 Stainless Steel

Increased corrosion resistance makes this product ideal for high-saline environments such as coastal regions and outdoor areas where de-icing salts are common.



Colours



Evergreen
(Standard)



Blue



Black



Gray

Colors apply to all units.

Foot Pedal Accessory

Convert outdoor bottle filling stations to hands-free units with this easy-to-install foot activation pedal. Order with a new unit or retrofit an existing one.

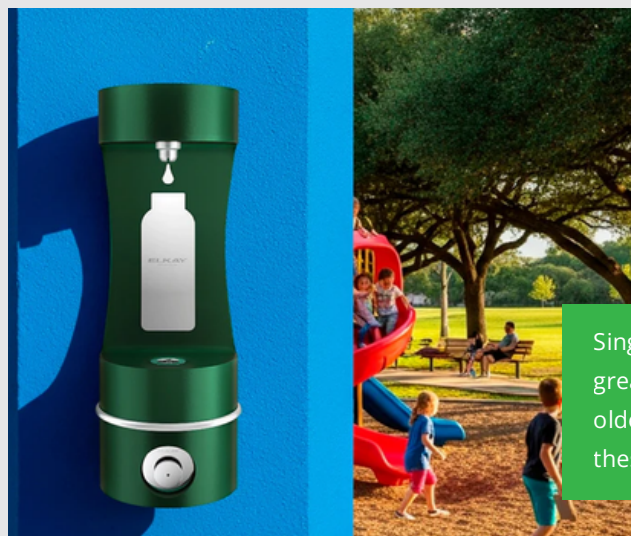

Wall-mount Models

With industry-leading construction, Elkay tubular wall-mount fountains and bottle filling stations are ideal for public spaces with high-traffic areas such as schools, parks and commercial buildings.

Single-line installation makes these units a great choice when upgrading or replacing older fountains. One waste line means these units are simple to maintain.

Features vary by model.

Elkay Outdoor EZH2O® Bottle Filling Station Pedestal



- **Bubbler:** Vandal-resistant bubbler is keyed in to prevent rotation
- **Activation:** Mechanical front push-button operation no electricity required
- **ADA:** Meets ADA standards when properly installed
- **Location:** Rated for outdoor service
- **Installation:** Floor mount / freestanding
- **Quick Fill Rate:** 1.1 GPH / 4.2 LPM
- **Dimensions (in):** (L) 17-15/16" x (W) 8-3/16" x (H) 25-7/16"
- **Dimensions (mm):** (L) 355 x (W) 355 x (H) 1625



AVAILABLE FINISHES / MATERIALS



BLACK



BLUE



EVERGREEN



GRAY

MODEL	MATERIAL cabinet	FINISH cabinet	FILTER	REFRIGERATION	SHIPPING WEIGHT
LK4400BFVGVWR	Heavy-Duty Steel	4 Colours Available	-	-	179 lbs (81 kg)

Elkay Outdoor EZH2O® Upper Bottle Filling Station Bi-Level Pedestal with Pet Station



- **Multifunctional:** Includes bottle filling station, drinking fountain and pet station; available in 4 colours
- **Bubbler:** Vandal-resistant bubbler is keyed in to prevent rotation
- **Activation:** Mechanical front push-button operation no electricity required
- **ADA:** Meets ADA standards when properly installed
- **Location:** Rated for outdoor service
- **Installation:** Floor mount / freestanding
- **Dimensions (in):** (L) 26" x (W) 31" x (H) 64"
- **Dimensions (mm):** (L) 710 x (W) 1170 x (H) 810

AVAILABLE FINISHES / MATERIALS



MODEL	MATERIAL cabinet	FINISH cabinet	FILTER	REFRIGERATION	SHIPPING WEIGHT
LK4420BF1UDB	Heavy-Duty Steel	4 Colours Available	-	-	205 lbs (93 kg)

Elkay Outdoor EZH2O® Single Arm Bottle Filling Station Wall Mount



- **Activation:** Mechanical front push-button operation no electricity required
- **Location:** Rated for outdoor service
- **ADA:** Meets ADA standards when properly installed
- **Installation:** Wall-mount
- **Dimensions (in):** (L) 10" × (W) 19-1/8" × (H) 32"
- **Dimensions (mm):** ((L) 480 × (W) 255 × (H) 815

AVAILABLE FINISHES / MATERIALS



MODEL	MATERIAL cabinet	FINISH cabinet	FILTER	REFRIGERATION	SHIPPING WEIGHT
LK4405BFEVG	Heavy-Duty Steel	4 Colours Available	-	-	~ 63 lbs (~ 28.5 kg)



ezH2O Liv® Water Dispensers

Deliver cleaner, healthier water in a sustainable way with ezH2O Liv® water dispensers. Available in two configurations — Liv Pro for commercial use and Liv for residential use — this sleek in-wall solution provides eco-friendly filtered water on demand. Designed to fit seamlessly virtually anywhere, this stylish water delivery solution requires a small footprint but delivers big results: cleaner, healthier drinking water.

Seamless Design

Fits within the width and depth of two wall studs near water and electric. Includes drip tray with optional drain connection; can connect into existing water line. Fits into new and existing spaces.

Bottles Saved

Backlit LED Green Ticker counts the number of disposable, single-use plastic bottles served without the plastic bottle waste.

Sensor Activated

Hands-free filling with automatic timed shut off to help prevent accidental spills and messes. Safety lock setting prevents unsupervised use.

Filtered Water

Filter is tested and certified to NSF/ANSI 42 and 53 for the reduction of lead and other harmful contaminants. Filter status lights indicate when the filter needs to be replaced.

Residential: 750-gallon filter

Commercial: 3,000-gallon filter

Convenient and Sustainable

Self-serve design allows people to help themselves to refreshing water, at home or in commercial spaces, in an eco-friendly way.

Chiller Option

Unit can be installed with or without a chiller. See product page for details.



Elkay EZH2O® Bottle Filling Station In-Wall



- **Filter:** WaterSentry Plus™ 3000 gallon / 11,356 litre filter (certified to NSD 42 and 53 for lead, particulate, chlorine, taste and odour reduction) with Visual LED Filter Monitor to indicate when replacement is necessary
- **Activation:** Electronic Bottle Filler Sensor
- **Hands-Free™:** Sanitary no-touch sensor activation with automatic 20 second shut off timer
- **Green Ticker™:** Counts the quantity of bottles saved from waste
- **Location:** Rated for indoor service
- **Installation:** In-wall
- **Quick Fill Rate:** 1.1-1.5 GPH / 4.2-5.7LPM
- **Power:** 220V / 50Hz
- **Dimensions (in):** (L) 19-3/4" x (W) 3-1/2" x (H) 40-13/16"
- **Dimensions (mm):** (L) 80 × (W) 480 × (H) 1020



MODEL	MATERIAL cabinet	FINISH cabinet	FILTER	REFRIGERATION	SHIPPING WEIGHT
LZWSM82K	Stainless Steel	Stainless Steel	Optional	8 GPH / 30 LPH	80 lbs (37 kg)

Elkay EZH20 Liv® Pro Built-in Filtered Chilled or Non-Chilled Water Dispenser



- **Filter:** Certified to reduce lead, PFAS, taste/odor, microplastics etc.
- **Activation:** Electronic Bottle Filler Sensor
- **Hands-Free™:** Sanitary no-touch sensor activation with automatic timed shut-off
- **Green Ticker™:** Backlit LED counter showing number of single-use bottles saved
- **Location:** Rated for indoor service
- **Installation:** In-wall
- **Quick Fill Rate:** 1.5 GPH
- **Power:** 115V / 60Hz (chilled) | 220-240V / 50-60Hz (non-chilled)
- **Dimensions (in):** (L) 5-1/8" x (W) 18" x (H) 28"
- **Dimensions (mm):** (L) 460 × (W) 130 × (H) 510

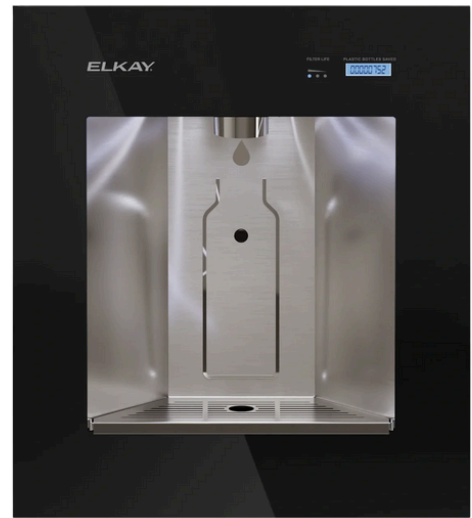

MODEL	MATERIAL cabinet	FINISH cabinet	FILTER	REFRIGERATION	SHIPPING WEIGHT
LBWD06BKK	Stainless Steel	Glass front / Midnight	✓	Refrigerated (remote chiller)	40 lbs (18 kg)
LBWD2C00BKC	Stainless Steel	Glass front / Midnight	✓	-	40 lbs (18 kg)

Elkay EZH2O Liv® Pro In-Wall Commercial Filtered Water Dispenser



- **Filter:** Certified reduction of lead and other contaminants; includes visual filter-status lights
- **Activation:** Electronic Bottle Filler Sensor
- **Hands-Free™:** Sensor-activated, touch-free bottle filling with timed automatic shut-off
- **Green Ticker™:** Backlit LED counter showing number of single-use bottles saved
- **Location:** Rated for indoor service
- **Installation:** In-wall
- **Quick Fill Rate:** 1.5 GPH
- **Power:** 220-240V 50 / 60Hz
- **Dimensions (in):** (L) 5-1/8" x (W) 18" x (H) 28"
- **Dimensions (mm):** (L) 460 x (W) 130 x (H) 510

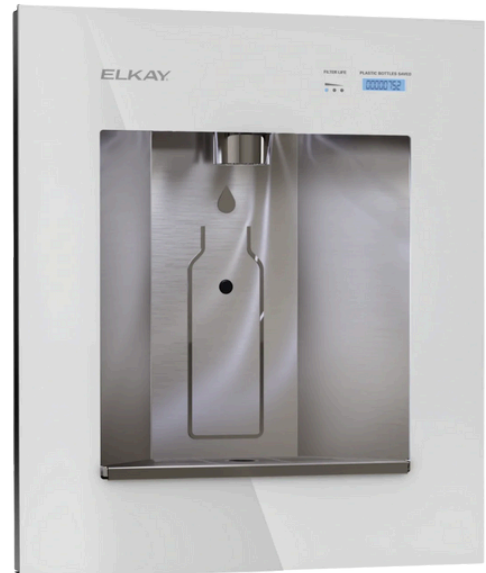

MODEL	MATERIAL cabinet	FINISH cabinet	FILTER	REFRIGERATION	SHIPPING WEIGHT
LBWD2C00WHC	Stainless Steel	Glass Front / Aspen White	✓	-	40 lbs (18 kg)

Liv EZ Mechanical Built-in Filtered Water Dispenser



- **Filter:** Certified to reduce lead, PFAS (PFOA/PFOS), micro-plastics, taste & odor.
- **Activation:** Mechanical Bottle Filler Button
- **Green Ticker™:** Counts the quantity of bottles saved from waste
- **Location:** Rated for indoor service
- **Installation:** In-wall
- **Dimensions (in):** (L) 4-9/16" × (W) 16-3/4" × (H) 20-1/2"
- **Dimensions (mm):** (L) 410 × (W) 105 × (H) 520



MODEL	MATERIAL cabinet	FINISH cabinet	FILTER	REFRIGERATION	SHIPPING WEIGHT
LBWDM0BKBC	Stainless Steel	Glass front / Midnight	✓	-	29 lbs (14 kg)



WATER
REFILL
GROUP
SUSTAINABLE HYDRATION