

# Relative and absolute pressure switch type 529

Pressure range  
-1 ... 0 – 60 bar



The compact type 529 pressure transmitter is based upon the Huba Control developed unique ceramic technology used for the last 20 years in millions of applications.

Either an N/C or N/O contact may be used, and the upper and lower switching point can be freely selected. Various electrical and pressure connections are available to suit given applications.

- Compact, rugged construction
- Negligible temperature influence on accuracy
- Saving time by quick cable mounting by the customer with swift connector
- Large selection of connections available.

## Technical overview

### Pressure range

Relative	-1 ... 0 – 60 bar
Absolute	0 ... 1 – 16 bar

### Operating conditions

Medium		Liquids and gases	
Temperature	Medium	FPM	-15 ... +125 °C
		EPDM	-40 ... +125 °C
		NBR	-20 ... +100 °C
		MVQ	-40 ... +125 °C
		Ambient	-30 ... +85 °C
Storage		-50 ... +100 °C	
Tolerable overload / Rupture pressure	≤ 4 bar	3.0 x fs	
	> 4 bar	2.5 x fs	

### Materialien

Pressure Connection		Stainless steel 1.4404 / AISI 316L
Plug accommodation		Polyarylamide 50% GF VO
Materials in contact with medium	Pressure connection	Stainless steel 1.4404 / AISI 316L
	Sensor	Ceramic Al <sub>2</sub> O <sub>3</sub> (96%)
	Sealing material	FPM, EPDM, NBR, MVQ

### Electrical overview

Output		Semiconductor (open collector)
Switching contact	High-Side Switch (PNP)	N/C contact or N/O contact
Switch last	High-Side Switch (PNP)	max. 200 mA
Power supply		7 ... 33 VDC
Current consumption		< 4 mA
Insulation voltage		500 VDC

### Protection class

Protection class III

### Dynamic response

Response time	< 2 ms, 1 ms typ.
Load cycle	< 100 Hz

### Adjustment of switching points (factory set)

Upper switching point	8 ... 100% fs
Lower switching point	5 ... 97% fs
Hysteresis	≥ 3 % fs

### Protection standard

IP 67

### Electrical connection

Swift connector without or with cable 1.5 m  
Connector M12x1

### Druckanschluss

Inside thread	G ¼	with O-Ring seal FPM spec. (-30 ... +135 °C)
	¼ -18 NPT	
Outside thread	G ¼	sealed at back DIN 3852 form E with Profile seal ring in FPM spec. (-30 ... +135 °C)
	R ¼	DIN 2999
	G ½	sealed at back and manometer (combi) with Profile seal ring in FPM spec. (-30 ... +135 °C)
	G ½	sealed at front

### Installation arrangement

Unrestricted

### Tests / Admissions

Electromagnetic compatibility	CE conformity acc. EN 61326-2-3
Shock acc. IEC IEC 68-2-27	100 g, 11 ms half sine wave, all 6 directions, free fall from 1 m on concrete (6x)
Constant shock acc. IEC 68-2-29	40 g for 6 ms, 1000x all 3 directions
Vibration acc. IEC 68-2-6	20 g, 15 ... 2000 Hz, 15 ... 25 Hz with amplitude ± 15 mm, 1 Octave/min. all 3 directions, 50 constant load

### Weight

~ 90 g

### Packaging (Please state on order)

Single packaging in cardboard	accessories integrated
Multiple packaging in cardboard (25 pcs)	





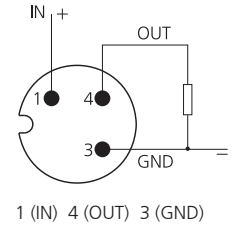
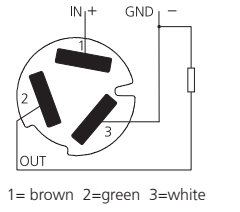
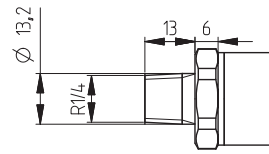
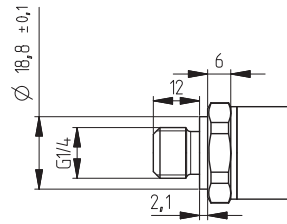
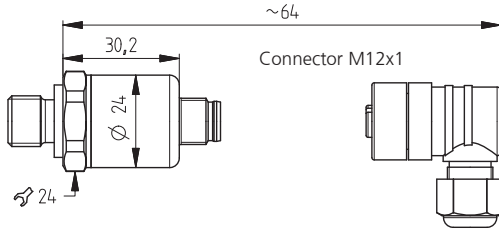
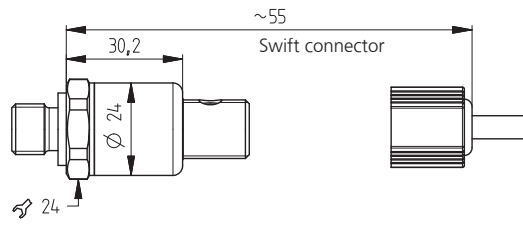
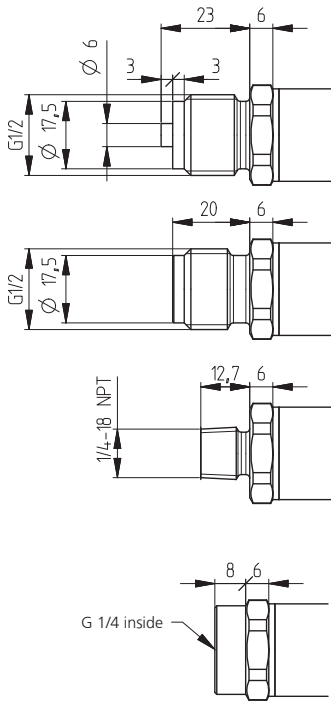

**Huba Control AG****Headquarters**

Industriestrasse 17  
5436 Würenlos  
Telefon +41 (0) 56 436 82 00  
Telefax +41 (0) 56 436 82 82  
info.ch@hubacontrol.com

**Huba Control AG****Niederlassung Deutschland**

Schlattgrabenstrasse 24  
72141 Walddorfhäslach  
Telefon +49 (0) 7127 23 93 00  
Telefax +49 (0) 7127 23 93 20  
info.de@hubacontrol.com

**Huba Control SA****Succursale France**

Rue Lavoisier  
Technopôle Forbach-Sud  
57602 Forbach Cedex  
Téléphone +33 (0) 387 847 300  
Télécopieur +33 (0) 387 847 301  
info.fr@hubacontrol.com

**Huba Control AG****Vestiging Nederland**

Hamseweg 20A  
3828 AD Hoogland  
Telefoon +31 (0) 33 433 03 66  
Telefax +31 (0) 33 433 03 77  
info.nl@hubacontrol.com

**Huba Control AG****Branch Office United Kingdom**

Unit 13 Berkshire House  
County Park Business Centre  
Shrivenham Road  
Swindon - Wiltshire SN1 2NR  
Phone +44 (0) 1993 776667  
Fax +44 (0) 1993 776671  
info.uk@hubacontrol.com