

**DETROIT  CABINET  
MANUFACTURING**

**A GSA DIRECT SUPPLY OWNED COMPANY**

Routed Slab Door



## DCM QUALITY PLYWOOD KITCHEN & BATH CABINETS MEET AND/OR EXCEED "SEVERE USE HUD" GUIDE.

### 1. FACE FRAME

- Kiln dried Poplar wood.
- Mortise and tenon, glued and power nailed
- Rails  $\frac{3}{4}$ "x $1\frac{3}{4}$ ", Styles  $\frac{3}{4}$ "x $1\frac{3}{4}$ ", Center Styles  $\frac{3}{4}$ "x3"

### 2. END PANELS

- $\frac{1}{2}$ " Baltic Birch plywood.
- Ends to be rabbeted to receive tops, bottoms and shelves-glued and stapled into face frame.

### 3. BACKS

- $\frac{1}{4}$ " Baltic Birch plywood, dadoes into  $\frac{3}{4}$ " Poplar nailers.
- Securely glued and stapled to ends.

### 4. BASE BOTTOMS

- $\frac{1}{2}$ " thick Baltic Birch plywood.
- Bottoms let into end panels and face frame.
- Back of floor set on supporting member, glued and fastened.

### 5. WALL TOP / BOTTOM

- $\frac{1}{2}$ " Baltic Birch plywood
- Top/bottoms dadoes into end panels and face frame, glued and fastened with wood blocks.

### 6. INSTALLATION CLEATS

- Wall cabinets have a  $\frac{3}{4}$ "x $3\frac{1}{2}$ " solid  $\frac{3}{4}$ " Poplar nailers, full length of cabinet at top and bottom.
- Base cabinets have a  $7\frac{1}{2}$ " cleat at the top and  $3\frac{1}{2}$ " cleat at the bottom.

### 7. DOOR AND DRAWER FACES -

- $\frac{3}{4}$ " Russian Birch hardwood
- Overlay type with edges
- reversed (reverse bevel) to form a continuous finger pull on all sides.
- Edges filled and sanded prior to finishing.

### 8. FINISH (Early American)

- Consisting of stain from standard color selection, sealer and two top coats UV Finish.

### 9. SHELVING

- $\frac{3}{4}$ " Birch plywood with front edge.
- For wall and base cabinets shelves are let into dadoes of end panels.

### 10. DRAWERS

- Drawer fronts are same material as doors.
- Sides, backs and fronts are  $\frac{3}{4}$ " thick Poplar solid wood.
- Sides are mortised and tenoned into front and back.
- Drawer bottoms are  $\frac{1}{4}$ " Birch plywood let into sides, front and back components.

### 11. TOE KICK

- $\frac{3}{4}$ "x3  $\frac{1}{2}$ " pressure treated solid wood.
- Toe kick is inset 3"

### 12. HARDWARE

- Hinges: barrel antique brass fin. standard heavy duty semi-concealed,  $\frac{1}{2}$ " overlay, wrap.
- Drawer slides are galvanised metal ball-bearing, mounted on the side rails with metal rear mount brackets having a minimum of 75 pound load capacity.
- Bumper pads are clear rubber.

DADOED INTO FRAME AND SIDES

3/4 STRECHERS

3/4 NAILERS

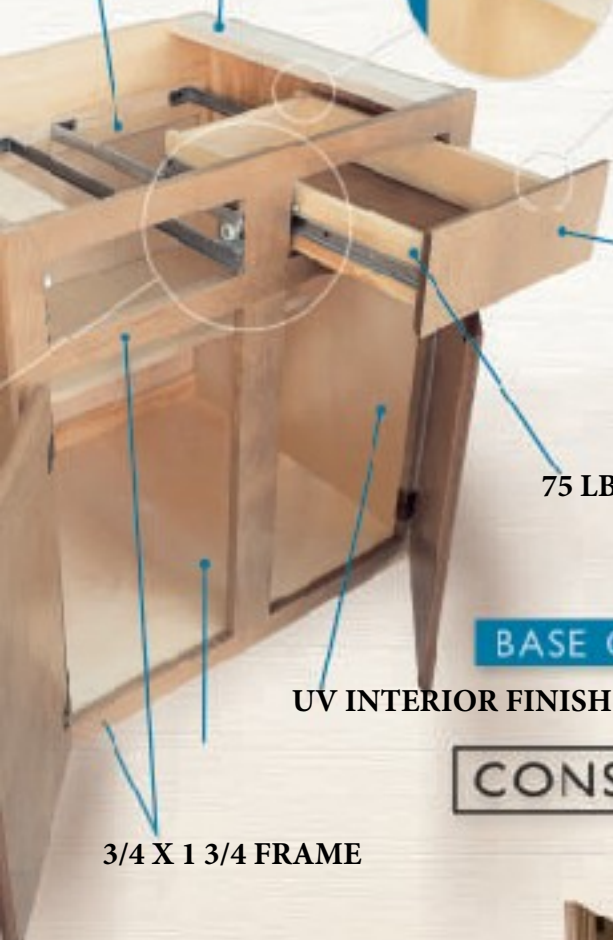

SLAB BIRCH DRAWERS

75 LB DRAWER GLIDES

SLAB BIRCH DOOR

BASE CABINET

1/2 BIRCH SIDES

UV INTERIOR FINISH

CONSTRUCTION DETAILS

3/4 TREATED LUMBER

3/4 X 1 3/4 FRAME

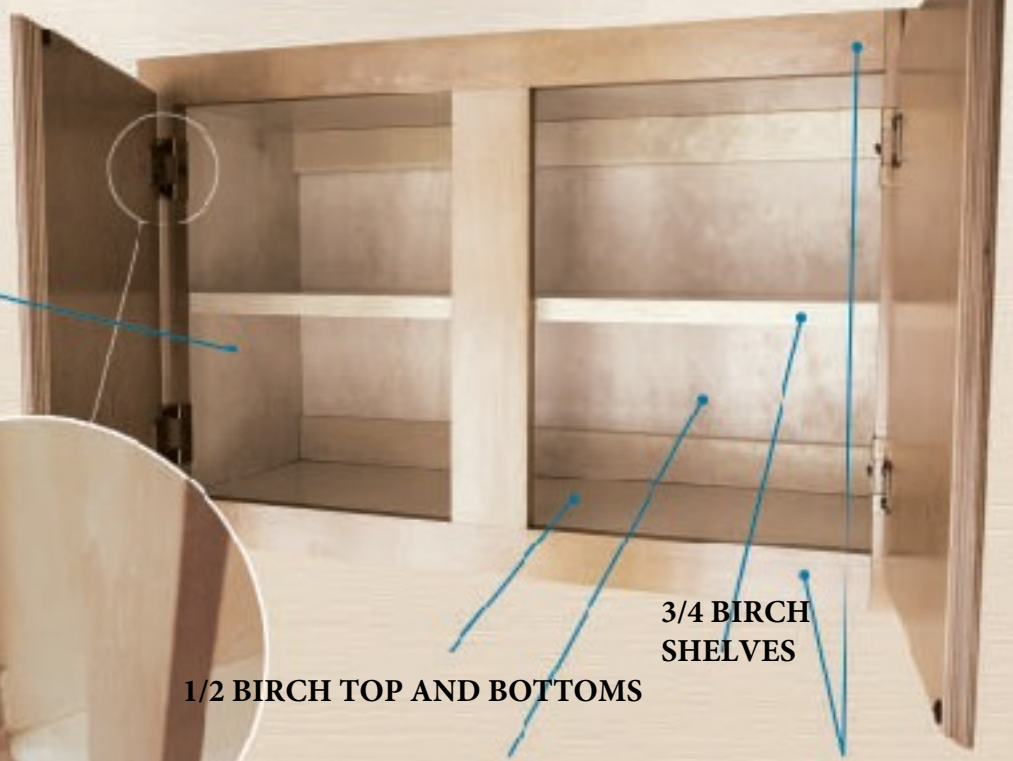

3/4 BIRCH SHELVES

1/2 BIRCH TOP AND BOTTOMS

1/4 BIRCH UV INTERIOR BACK

WALL CABINET

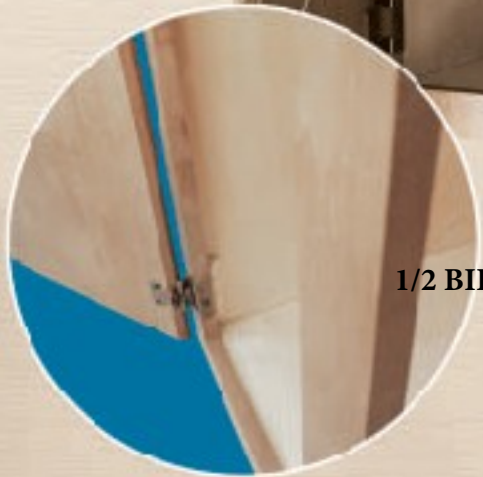

2



SOLID ROUTED DOOR



SLAB (FINGER  
PULL)

For over 25 years, DCM has specialized in HUD Approved Kitchen Cabinets

### "DETROIT HUD"

**kitchen cabinet** line is just one example of our commitment to provide quality and sturdy kitchen cabinets. Combining cutting edge technology with the use of only top quality materials, we are able to offer our customers products that

**COLORS AVAILABLE  
CUSTOM COLOR MATCH**

**DETROIT  CABINET  
MANUFACTURING**

**12908 W SEVEN MILE  
DETROIT MI 48235  
PH 313-734-6754 313-528-9298  
EMAIL: [mphillips@detroitcabinets.kitchen](mailto:mphillips@detroitcabinets.kitchen)  
[sales@detroitcabinets.kitchen](mailto:sales@detroitcabinets.kitchen)  
[www.detroitcabinets.kitchen](http://www.detroitcabinets.kitchen)**