

THE INTERNATIONAL CENTRE

Full Facility

FULL FACILITY DIMENSION

Total Square Feet	500,000	Ceiling Clearance	13' - 42'
Loading Docks	50	Dock Dimensions (w x h)	9' - 10' 11" x 8' - 9'
Drive-In Doors	8	Drive-In Doors Dimensions (w x h)	12' x 13'

¹10 people per round table, ²Based on booth dimension of 10'x10'. Certain set-ups, layouts, and A/V will reduce capacities. Floorplan specifications subject to change without notice. All rights reserved. E. & O.E. October 2023.

LEGEND

	RESERVED DOORS		FHFHC FIRE HOSE/FIRE HOSE CABINET
	LOADING DOORS		FIRE EXIT
	MAN DOORS		TEMPORARY EMERGENCY EXIT
	DRIVE-IN DOORS		MENS WASHROOM
	ROLL-UP DOORS		WOMENS WASHROOM
	MARKED ROLL-UP DOORS		BARRIER FREE WASHROOM
	BANK MACHINE		FAMILY WASHROOM
	FLOOR DRAIN		BABY CHANGE COUNTER
	MUST LEAVE ACCESS		PERMANENT FOOD AREA

CEILING HEIGHTS PER HALL
(for critical areas see floor plan)

HALL 1 = 33'
HALL 1 DOCKS = 15'
HALL 2 = 23'
HALL 2 DOCKS = 18'
HALL 3-4 = 20'
HALL 5 = 23'
HALL 6 = 20'

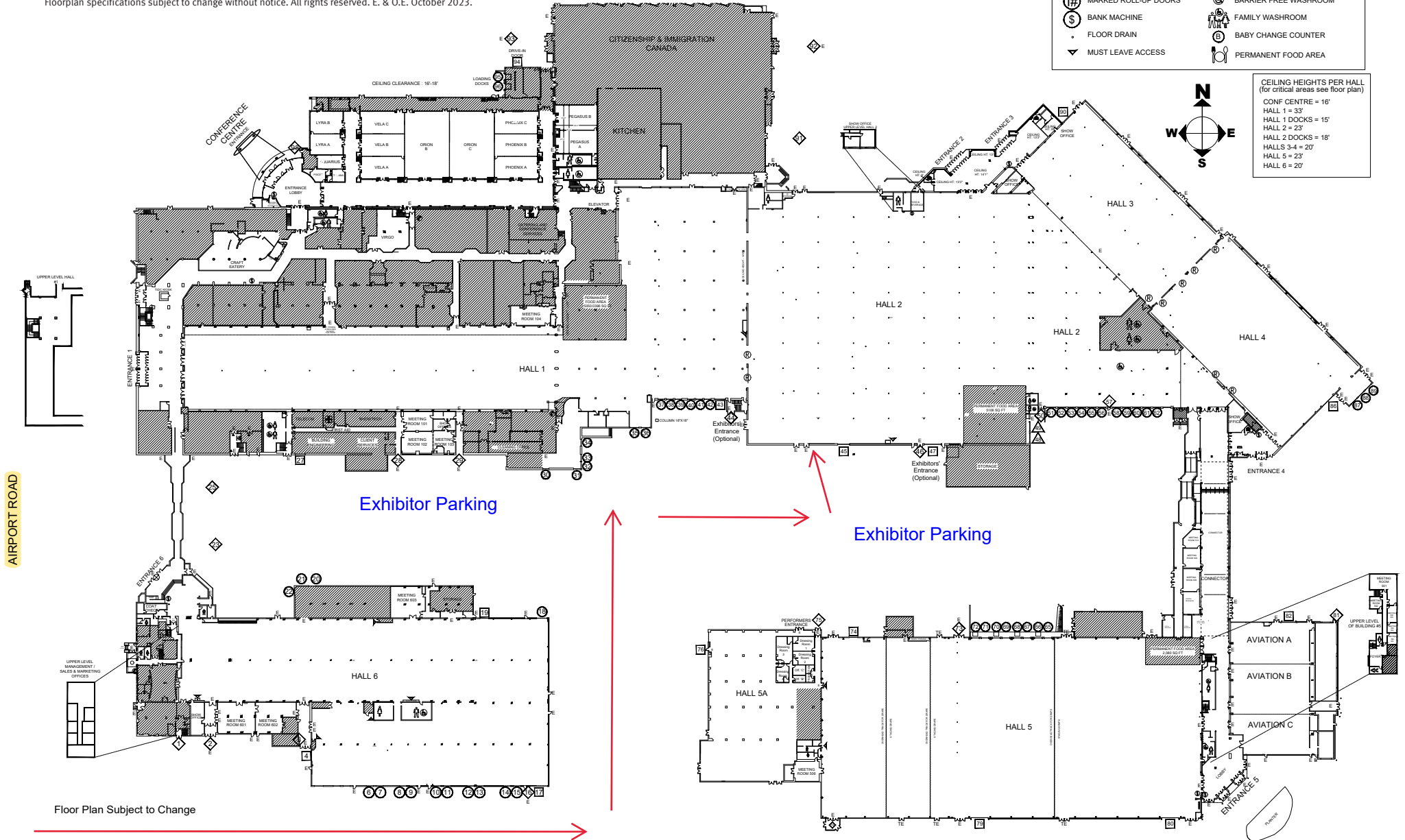

AIRPORT ROAD

Floor Plan Subject to Change